

Pipes

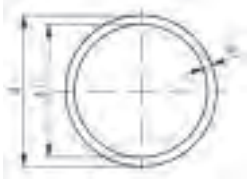

Pipe PVC-U grey Series S6,3 SDR13,6 nominal pressure PN16

Model:

- Material: PVC-U, Polyvinylchloride unplasticised DIN 8061
- Colour: RAL 7011 - dark-grey
- Dimension: DIN EN ISO 15493, DIN 8062
- Pipe length: 5m, with plain ends
- Minimum order quantity: 1 length
- DIBT Z-40.23-1 from d20

d (mm)	Size (NB) (inch)	PN (bar)	Code	Weight (kg/m)	e (mm)	di (mm)
12		16	161 017 104	0.055	1.0	10.0
16		16	161 017 105	0.090	1.2	13.6
20		16	161 017 106	0.137	1.5	17.0
25		16	161 017 107	0.212	1.9	21.2
32		16	161 017 108	0.342	2.4	27.2
40		16	161 017 109	0.525	3.0	34.0
50		16	161 017 110	0.809	3.7	42.6
63		16	161 017 111	1.290	4.7	53.6
75	2 ½	16	161 017 112	1.820	5.6	58.2
90		16	161 017 113	2.610	6.7	76.6
110		16	161 017 114	3.856	8.1	93.8
125		16	161 017 115	4.956	9.2	106.6
140	5	16	161 017 116	6.215	10.3	119.4
160		16	161 017 117	8.109	11.8	136.4

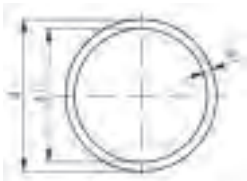

Pipe PVC-U grey Series S4 SDR9 nominal pressure PN16

Model:

- Material: PVC-U, Polyvinylchloride unplasticised DIN 8061
- Colour: RAL 7011 - dark-grey
- Dimension: DIN EN ISO 15493, DIN 8062
- Pipe length: 5m, with plain ends
- **Increased wall thickness for industrial use**
- Minimum order quantity: 1 length
- DIBT Z-40.23-1 from d16

d (mm)	PN (bar)	Code	Weight (kg/m)	e (mm)	di (mm)
6	16	161 017 126	0.025	1.0	4.0
8	16	161 017 127	0.035	1.0	6.0
10	16	161 017 128	0.053	1.2	7.6
12	16	161 017 129	0.073	1.4	9.2
16	16	161 017 130	0.123	1.8	12.4
20	16	161 017 131	0.196	2.3	15.4
25	16	161 017 132	0.294	2.8	19.4
32	16	161 017 133	0.482	3.6	24.8
40	16	161 017 134	0.750	4.5	31.0
50	16	161 017 135	1.160	5.6	38.8
63	16	161 017 136	1.820	7.0	49.0
75	16	161 017 137	2.600	8.4	58.2
90	16	161 017 138	3.700	10.0	70.0
110	16	161 017 139	5.560	12.3	85.4

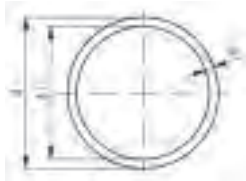

Pipe PVC-U grey
Series S10 SDR21 nominal pressure PN10

Model:

- Material: PVC-U, Polyvinylchloride unplasticised DIN 8061
- Colour: RAL 7011 - dark-grey
- Dimension: DIN EN ISO 15493, DIN 8062
- Pipe length: 5m, with plain ends
- Minimum order quantity: 1 length
- DIBT Z-40.23-1 until d225

d (mm)	PN (bar)	Code	Weight (kg/m)	e (mm)	di (mm)
25	10	161 017 082	0.174	1.5	22.0
32	10	161 017 083	0.276	1.8	28.4
40	10	161 017 084	0.350	1.9	36.2
50	10	161 017 085	0.552	2.4	45.2
63	10	161 017 086	0.854	3.0	57.0
75	10	161 017 087	1.220	3.6	67.8
90	10	161 017 088	1.750	4.3	81.4
110	10	161 017 089	2.610	5.3	99.4
125	10	161 017 090	3.340	6.0	113.0
140	10	161 017 091	4.180	6.7	126.6
160	10	161 017 092	5.470	7.6	144.7
180	10	161 017 093	6.880	8.6	162.8
200	10	161 017 094	8.510	9.6	180.8
225	10	161 017 095	10.800	10.8	203.4
250	10	161 017 096	13.200	11.9	226.2
280	10	161 017 097	16.600	13.4	253.2
315	6	161 017 098	20.900	15.0	285.0

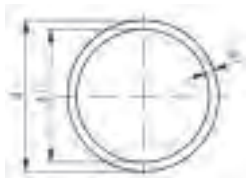

Pipe PVC-U transparent
Series S16.7 SDR34.3

Model:

- Material: PVC-U, Polyvinylchloride unplasticised DIN 8061
- Colour: transparent
- Dimension: DIN EN ISO 15493, DIN 8062
- Pipe length: 5m, with plain ends
- The material used fullfills the requirements of DIN 8061 in all aspects except longterm pressure test
- Minimum order quantity: 1 length

d (mm)	PN (bar)	Code	Weight (kg/m)	e (mm)	di (mm)
50	6	192 017 060	0.422	1.8	46.4
160	6	192 017 080	3.440	4.7	150.6



**Pipe PVC-U transparent
Series S25 SDR51**

Model:

- Material: PVC-U, Polyvinylchloride unplasticised DIN 8061
- Colour: transparent
- Dimension: DIN EN ISO 15493, DIN 8062
- Pipe length: 5m, with plain ends
- The material used fullfills the requirements of DIN 8061 in all aspects except longterm pressure test
- Minimum order quantity: 1 length

d (mm)	PN (bar)	Code	Weight (kg/m)	e (mm)	di (mm)
63	4	192 017 036	0.532	1.8	59.4
75	4	192 017 037	0.642	1.8	71.4
90	4	192 017 038	0.774	1.8	86.4
110	4	192 017 039	1.160	2.2	105.6
125	4	192 017 040	1.480	2.5	120.0
140	4	192 017 041	1.840	2.8	134.4
160	4	192 017 042	2.410	3.2	153.6
200	4	192 017 044	3.700	4.0	192.0
225	4	192 017 045	4.700	4.5	216.0
250	4	192 017 046	5.650	4.9	240.2
280	4	192 017 047	7.600	5.5	269.0



**Pipe PVC-U transparent
Series S6.25 SDR13.5**

Model:

- Material: PVC-U, Polyvinylchloride unplasticised DIN 8061
- Colour: transparent
- Dimension: DIN EN ISO 15493, DIN 8062
- Pipe length: 5m, with plain ends
- The material used fullfills the requirements of DIN 8061 in all aspects except longterm pressure test
- Minimum order quantity: 1 length

d (mm)	PN (bar)	Code	Weight (kg/m)	e (mm)	di (mm)
12	16	192 017 104	0.055	1.0	10.0
16	16	192 017 105	0.090	1.2	13.6
20	16	192 017 106	0.137	1.5	17.0
25	16	192 017 107	0.212	1.9	21.2
32	16	192 017 108	0.342	2.4	27.2
40	16	192 017 109	0.525	3.0	34.0
50	16	192 017 110	0.809	3.7	42.6
63	16	192 017 111	1.290	4.7	53.6



**Pipe PVC-U transparent
Series S10 SDR21**

Model:

- Material: PVC-U, Polyvinylchloride unplasticised DIN 8061
- Colour: transparent
- Dimension: DIN EN ISO 15493, DIN 8062
- Pipe length: 5m, with plain ends
- Minimum order quantity: 1 length

d (mm)	PN (bar)	Code	Weight (kg/m)	e (mm)	di (mm)
25	10	192 017 082	0.174	1.5	22.0
32	10	192 017 083	0.264	1.8	28.4
40	10	192 017 084	0.366	1.9	36.2
50	10	192 017 085	0.552	2.4	45.2
63	10	192 017 086	0.854	3.0	57.0
75	10	192 017 087	1.220	3.6	67.8
90	10	192 017 088	1.750	4.3	81.4
110	10	192 017 089	2.610	5.3	99.4



**Pipe PVC-U grey
SDR34.3 nominal pressure PN6**

Model:

- Material: PVC-U, Polyvinylchloride unplasticised
- Colour: RAL 7011 - dark-grey
- Dimension: DIN EN ISO 15493, DIN 8062
- Pipe length: 5m, with plain ends
- Minimum order quantity: 1 length
- DIBT Z-40.23-1 until d225

d (mm)	PN (bar)	Code	Weight (kg)	e (mm)	di (mm)
50	6	161 017 060	0.422	1.8	46.4
63	6	161 017 061	0.562	1.9	59.2
75	6	161 017 062	0.782	2.2	70.6
90	6	161 017 063	1.130	2.7	84.6
110	6	161 017 064	1.640	3.2	103.6
125	6	161 017 065	2.130	3.7	117.6
140	6	161 017 066	2.650	4.1	131.8
160	6	161 017 067	3.440	4.7	150.6
180	6	161 017 068	4.370	5.3	169.4
200	6	161 017 069	5.370	5.9	188.2
225	6	161 017 070	6.760	6.6	211.6
250	6	161 017 071	8.310	7.3	235.4
315	6	161 017 072	13.200	9.2	296.6
355	6	161 017 073	16.700	10.4	334.2
400	6	161 017 074	21.100	11.7	376.6

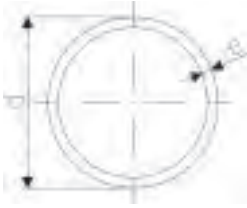

Pipe PVC-U grey
SDR51 nominal pressure PN4

Model:

- Material: PVC-U, Polyvinylchloride unplasticised
- Colour: RAL 7011 - dark-grey
- Dimension: DIN EN ISO 15493, DIN 8062
- Pipe length: 5m, with plain ends
- Minimum order quantity: 1 length

d (mm)	PN (bar)	Code	Weight (kg/m)	e (mm)	di (mm)
75	4	161 017 037	0.642	1.8	71.4
90	4	161 017 038	0.774	1.8	86.4
110	4	161 017 039	1.160	2.2	105.6
125	4	161 017 040	1.480	2.5	120.0
140	4	161 017 041	1.840	2.8	134.4
160	4	161 017 042	2.410	3.2	153.6
180	4	161 017 043	3.020	3.6	172.8
200	4	161 017 044	3.700	4.0	192.0
225	4	161 017 045	4.700	4.5	216.0
250	4	161 017 046	5.650	4.9	240.2
280	4	161 017 047	7.110	5.5	269.0
315	4	161 017 048	9.020	6.2	302.6

Fittings



Bend 90° PVC-U metric

d (mm)	PN (bar)	Code	Weight (kg)	z (mm)	D (mm)	L (mm)
20	16	721 000 106	0.029	40	27	56
25	16	721 000 107	0.049	50	33	69
32	16	721 000 108	0.074	64	38	86
40	16	721 000 109	0.121	80	47	106
50	16	721 000 110	0.298	100	61	131
63	16	721 000 111	0.516	126	76	164
75	16	721 000 112	0.798	150	90	194
90	16	721 000 113	1.373	180	108	231
110	16	721 000 114	2.699	220	137	281
140	16	721 000 116	5.204	280	168	356
160	16	721 000 117	8.298	320	192	406

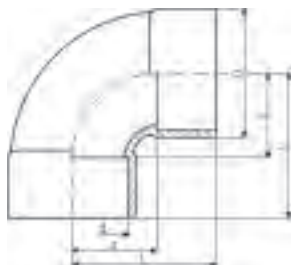

Bend 90° short pattern PVC-U metric

d (mm)	PN (bar)	Code	Weight (kg)	z (mm)	D (mm)	L (mm)
225	10	721 010 120	7.554	168	256	287
280	10	721 010 122	16.987	210	318	357
315	6	721 010 123	21.567	237	356	402
400	6	721 010 125	30.000	300	442	521



Elbow 90° PVC-U metric

d (mm)	d (inch)	PN (bar)	Code	Weight (kg)	z (mm)	D (mm)	L (mm)
6		16	721 100 101	0.004	4	11	16
8		16	721 100 102	0.004	5	13	17
10		16	721 100 103	0.004	6	14	18
12		16	721 100 104	0.006	7	17	19
16		16	721 100 105	0.007	9	21	23
20		16	721 100 106	0.012	11	25	27
25		16	721 100 107	0.024	14	32	33
32		16	721 100 108	0.043	17	40	39
40		16	721 100 109	0.062	23	47	49
50		16	721 100 110	0.106	26	59	57
63		16	721 100 111	0.205	33	73	71
75	2 1/2	16	721 100 112	0.336	40	87	83
90		16	721 100 113	0.576	46	105	97
110		16	721 100 114	1.009	55	128	116
125		16	721 100 115	1.522	63	146	131
140	5	16	721 100 116	1.945	70	162	146
160		16	721 100 117	2.873	80	185	166
200		10	721 100 119	4.446	101	225	207
225		10	721 100 120	5.989	114	252	233
250		10	721 100 121	10.014	131	282	263

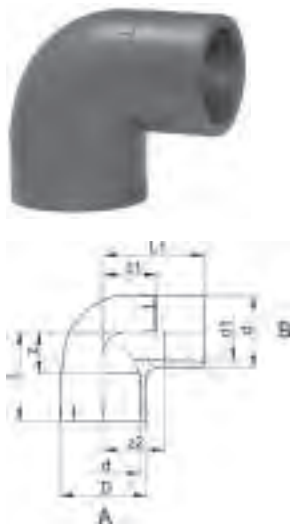

PRO-FIT elbow 90° PVC-U metric

Model:

- Outlet: A = solvent cemented socket metric
- Outlet: B = solvent cemented spigot in combination with reducing socket metric
- Direct connection from fitting to fitting allowing shortest possible overall length

d (mm)	d1 (mm)	PN (bar)	Code	Weight (kg)	z (mm)	z1 (mm)	z2 (mm)	D (mm)	L (mm)	L1 (mm)
20	16	16	721 100 306	0.011	11	16	18	25	27	32
25	20	16	721 100 307	0.020	14	18	21	31	33	37
32	25	16	721 100 308	0.038	17	22	25	38	39	44
40	32	16	721 100 309	0.069	23	30	34	47	49	56
50	40	16	721 100 310	0.122	26	36	41	58	57	67
63	50	16	721 100 311	0.237	33	45	52	73	71	83



PRO-FIT elbow 45° PVC-U metric

Model:

- Outlet: A = solvent cemented socket metric
- Outlet: B = solvent cemented spigot in combination with reducing socket metric
- Direct connection from fitting to fitting allowing shortest possible overall length

d (mm)	d1 (mm)	PN (bar)	Code	Weight (kg)	z (mm)	z1 (mm)	z2 (mm)	D (mm)	L (mm)	L1 (mm)
20	16	16	721 150 306	0.010	5	9	11	25	21	25
25	20	16	721 150 307	0.015	6	11	14	31	25	30
32	25	16	721 150 308	0.027	8	13	16	38	30	35
40	32	16	721 150 309	0.053	10	17	21	47	36	43
50	40	16	721 150 310	0.090	12	18	23	58	43	49
63	50	16	721 150 311	0.175	14	23	30	73	52	61



Elbow 45° PVC-U metric

d (mm)	d (inch)	PN (bar)	Code	Weight (kg)	z (mm)	D (mm)	L (mm)
16		16	721 150 105	0.008	5	21	19
20		16	721 150 106	0.011	5	25	21
25		16	721 150 107	0.017	6	31	25
32		16	721 150 108	0.021	8	38	30
40		16	721 150 109	0.048	10	47	36
50		16	721 150 110	0.086	12	59	43
63		16	721 150 111	0.160	14	73	52
75	2 ½	16	721 150 112	0.253	17	87	61
90		16	721 150 113	0.430	20	105	71
110		16	721 150 114	0.750	25	127	86
125		16	721 150 115	1.193	28	146	97
140	5	16	721 150 116	1.570	32	162	108
160		16	721 150 117	2.280	36	185	122
200		10	721 150 119	3.288	43	225	149
225		10	721 150 120	4.191	49	250	168
250		10	721 150 121	7.115	60	282	192
280		10	721 150 122	10.340	66	318	213
315		6	721 150 123	14.292	74	356	239
400		6	721 150 125	25.268	94	442	302



Tee 90° equal PVC-U metric

d (mm)	d (inch)	PN (bar)	Code	Weight (kg)	D (mm)	L (mm)	z (mm)
6		16	721 200 101	0.004	11	16	4
8		16	721 200 102	0.008	13	17	5
10		16	721 200 103	0.008	16	18	6
12		16	721 200 104	0.011	19	19	7
16		16	721 200 105	0.011	21	23	9
20		16	721 200 106	0.019	25	27	11
25		16	721 200 107	0.029	31	33	14
32		16	721 200 108	0.055	38	39	17
40		16	721 200 109	0.100	48	49	23
50		16	721 200 110	0.156	58	57	26
63		16	721 200 111	0.291	73	71	33
75	2 1/2	16	721 200 112	0.476	87	83	39
90		16	721 200 113	0.824	105	97	46
110		16	721 200 114	1.411	127	116	55
125		16	721 200 115	2.521	151	135	66
140	5	16	721 200 116	3.410	169	147	71
160		16	721 200 117	4.982	193	167	81
200		10	721 200 119	5.868	225	207	101
225		10	721 200 120	9.268	256	233	114
250		10	721 200 121	14.350	282	263	132
280		10	721 200 122	19.541	318	298	152
315		6	721 200 123	27.254	356	332	168
400		6	721 200 125	35.000	442	420	214

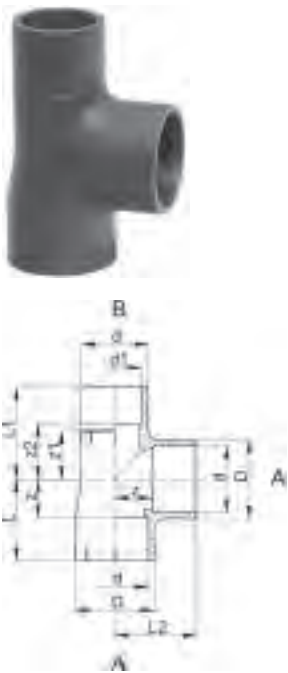

PRO-FIT tee 90° equal PVC-U metric

Model:

- Outlet: A = solvent cemented socket metric
- Outlet: B = solvent cemented spigot in combination with reducing socket metric
- Direct connection from fitting to fitting allowing shortest possible overall length

d (mm)	d1 (mm)	PN (bar)	Code	Weight (kg)	z (mm)	z1 (mm)	z2 (mm)	D (mm)	L (mm)	L1 (mm)	L2 (mm)
20	16	16	721 200 306	0.017	11	17	19	25	27	33	27
25	20	16	721 200 307	0.022	14	19	22	31	33	38	33
32	25	16	721 200 308	0.051	17	24	27	38	39	46	39
40	32	16	721 200 309	0.098	23	30	34	47	47	56	49
50	40	16	721 200 310	0.164	26	36	41	58	57	67	57
63	50	16	721 200 311	0.329	33	45	52	73	71	83	71

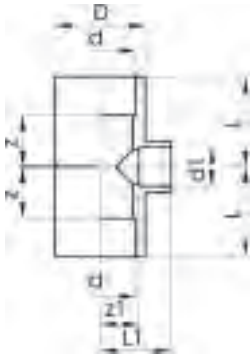

Tee 90° reducing PVC-U metric

d (mm)	d1 (mm)	PN (bar)	d-d (inch)	Code	Weight (kg)	z (mm)	z1 (mm)	D (mm)	L (mm)	L1 (mm)
25	20	16		721 200 134	0.038	14	14	33	33	30
32	20	16		721 200 141	0.061	17	17	41	39	33
32	25	16		721 200 138	0.063	17	17	41	39	36
40	20	16		721 200 155	0.103	23	23	50	49	39
40	25	16		721 200 151	0.107	23	23	50	49	42
40	32	16		721 200 147	0.109	23	23	50	49	45
50	20	16		721 200 009	0.179	28	28	62	59	44
50	25	16		721 200 010	0.183	28	28	62	59	47
50	32	16		721 200 164	0.189	28	28	62	59	50
50	40	16		721 200 161	0.208	28	28	62	59	54
63	25	16		721 200 011	0.332	35	34	77	73	53
63	32	16		721 200 178	0.336	35	34	77	73	56
63	40	16		721 200 174	0.347	35	34	77	73	60
63	50	16		721 200 170	0.354	35	34	77	73	65
75	32	16		721 200 181	0.535	40	41	92	84	63
75	40	16		721 200 182	0.555	40	41	92	84	67
75	50	16		721 200 183	0.541	40	41	92	84	72
75	63	16		721 200 184	0.570	40	41	92	84	79
90	32	16		721 200 142	0.855	46	55	110	97	77
90	50	16		721 200 144	0.907	46	55	110	97	86
90	63	16		721 200 145	0.931	46	55	110	97	93
90	75	16		721 200 146	0.959	46	55	110	97	99
110	32	16		721 200 135	1.441	56	67	133	117	89
110	50	16		721 200 136	1.471	56	67	133	117	98
110	63	16		721 200 132	1.522	56	65	133	117	103
110	75	16		721 200 133	1.543	56	65	133	117	109
110	90	16		721 200 137	1.634	56	65	133	117	116
125	50	16		721 200 139	1.970	64	75	151	133	106
125	90	16		721 200 140	2.200	64	75	151	133	126
140	50	16		721 200 148	3.235	72	82	172	148	113
140	75	16	5 - 2 1/2	721 200 149	3.319	72	78	172	148	122
140	110	16		721 200 150	3.422	72	74	172	148	135
160	110	16		721 200 152	4.305	81	81	192	167	142
200	110	10		721 200 153	8.782	107	131	232	213	192
200	160	10		721 200 154	8.036	107	106	232	213	192
225	110	10		721 200 156	10.619	120	143	257	239	204
225	160	10		721 200 157	9.760	120	119	257	239	205
250	160	10		721 200 159	14.520	132	151	282	263	237
250	200	10		721 200 162	12.213	132	131	282	263	237
280	160	10		721 200 165	18.402	120	180	318	266	266
280	225	10		721 200 167	16.145	120	148	318	266	268
315	160	6		721 200 169	22.189	120	197	356	284	283
315	225	6		721 200 172	20.154	120	165	356	284	284
400	225	6		721 200 176	40.000	163	258	442	369	377
400	315	6		721 200 180	35.000	163	213	442	369	377



Cross PVC-U metric

d (mm)	d (inch)	PN (bar)	Code	Weight (kg)	D (mm)	L (mm)	z (mm)
10		16	721 300 103	0.009	16	19	7
12		16	721 300 104	0.010	18	20	8
16		16	721 300 105	0.020	23	24	10
20		16	721 300 106	0.036	29	27	11
25		16	721 300 107	0.054	35	33	14
32		16	721 300 108	0.092	43	39	17
40		16	721 300 109	0.155	52	49	23
50		16	721 300 110	0.259	63	59	28
63		16	721 300 111	0.482	79	72	34
75	2 ½	10	721 300 112	0.725	92	83	40
90		10	721 300 113	1.221	106	97	48
110		10	721 300 114	2.111	128	117	59



Tee 45° PVC-U metric

d (mm)	d (inch)	PN (bar)	Code	Weight (kg)	z (mm)	z1 (mm)	D (mm)	L (mm)	L1 (mm)
10		10	721 250 103	0.013	18	4	16	46	30
12		10	721 250 104	0.014	21	4	18	49	33
16		10	721 250 105	0.022	25	5	23	58	39
20		10	721 250 106	0.035	30	6	28	68	46
25		10	721 250 107	0.056	36	9	33	83	55
32		10	721 250 108	0.096	45	10	41	99	67
40		10	721 250 109	0.159	56	10	50	118	82
50		10	721 250 110	0.265	66	12	60	140	97
63		10	721 250 111	0.439	85	14	74	175	123
75	2 ½	6	721 250 112	0.816	101	18	91	207	145
90		6	721 250 113	1.275	122	20	107	245	173
110		6	721 250 114	2.579	149	27	134	298	210
125		6	721 250 115	3.616	167	30	147	335	236
140	5	6	721 250 116	5.628	190	34	168	376	266
160		6	721 250 117	7.187	213	41	190	428	300
200		6	721 250 119	12.314	265	48	232	527	372
225		6	721 250 120	15.735	296	54	260	590	416
250		6	721 250 121	20.350	330	60	286	654	462



Socket equal PVC-U metric

¹ Socket d355 and d400 fabricated from pipe

d (mm)	d (inch)	PN (bar)	Code	Weight (kg)	z (mm)	D (mm)	L (mm)
6		16	721 910 101	0.004	3	12	27
8		16	721 910 102	0.005	3	14	27
10		16	721 910 103	0.004	3	16	27
12		16	721 910 104	0.004	3	19	27
16		16	721 910 105	0.006	3	22	31
20		16	721 910 106	0.011	3	26	35
25		16	721 910 107	0.015	3	32	41
32		16	721 910 108	0.026	3	39	47
40		16	721 910 109	0.045	3	48	55
50		16	721 910 110	0.064	3	58	65
63		16	721 910 111	0.118	3	73	79
75	2 ½	16	721 910 112	0.188	4	87	92

table continued on the next page



d (mm)	d (inch)	PN (bar)	Code	Weight (kg)	z (mm)	D (mm)	L (mm)
90		16	721 910 113	0.328	5	105	107
110		16	721 910 114	0.554	6	128	128
125		16	721 910 115	0.825	7	142	145
140	5	16	721 910 116	1.118	7	162	159
160		16	721 910 117	1.540	8	183	180
200		10	721 910 119	2.559	9	221	221
225		10	721 910 120	3.519	10	253	248
250		10	721 910 121	5.394	16	284	284
280		10	721 910 122	8.312	16	321	314
315		6	721 910 123	10.388	16	356	348
1	355	6	721 910 124	10.706	68	377	454
1	400	6	721 910 125	11.326	73	425	505



Socket equal PVC-U transparent metric

d (mm)	PN (bar)	Code	Weight (kg)	z (mm)	D (mm)	L (mm)
16	16	752 910 105	0.009	3	23	31
20	16	752 910 106	0.012	3	27	35
25	16	752 910 107	0.016	3	32	41
32	16	752 910 108	0.027	3	40	47
40	16	752 910 109	0.061	3	52	55
50	16	752 910 110	0.068	3	60	65
63	16	752 910 111	0.115	3	75	79

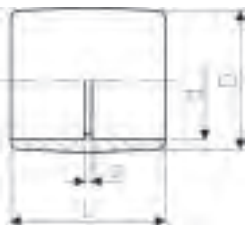

Adaptor socket PVC-U metric Inch/BS

Model:

- With solvent cement sockets metric and BS inch

d (mm)	d (inch)	PN (bar)	Code	Weight (kg)	z (mm)	D (mm)	L (mm)
16	¾	16	721 913 105	0.010	5	23	35
20	½	16	721 913 106	0.012	5	27	38
25	¾	16	721 913 107	0.020	5	33	45
32	1	16	721 913 108	0.031	5	41	51
40	1 ¼	16	721 913 109	0.054	5	51	60
50	1 ½	16	721 913 110	0.074	4	59	65
63	2	16	721 913 111	0.155	5	75	79
90	3	16	721 913 113	0.340	6	104	108
110	4	16	721 913 115	0.488	4	128	128



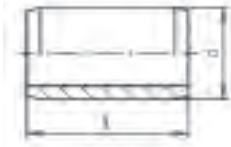

Barrel nipple PVC-U metric

Model:

- With solvent cement spigots on both sides
- Overall length L = 2 x socket length
- For the shortest possible distance between fittings

d (mm)	d (inch)	PN (bar)	Code	Weight (kg)	L (mm)
16		16	721 900 905	0.002	28
20		16	721 900 906	0.005	32
25		16	721 900 907	0.009	38
32		16	721 900 908	0.015	44
40		16	721 900 909	0.027	52
50		16	721 900 910	0.048	62
63		16	721 900 911	0.092	76
75	2 ½	16	721 900 912	0.156	88
90		16	721 900 913	0.260	102
110		16	721 900 914	0.455	122
125		16	721 900 915	0.673	138
140	5	16	721 900 916	0.932	152
160		16	721 900 917	1.565	192
200		10	721 900 919	1.779	212
225		10	721 900 920	2.566	238



Cap PVC-U metric

d (mm)	d (inch)	PN (bar)	Code	Weight (kg)	D (mm)	L (mm)
12		16	721 960 104	0.004	19	15
16		16	721 960 105	0.005	23	21
20		16	721 960 106	0.008	27	24
25		16	721 960 107	0.013	33	28
32		16	721 960 108	0.020	40	32
40		16	721 960 109	0.029	47	38
50		16	721 960 110	0.051	59	45
63		16	721 960 111	0.095	74	56
75	2 ½	16	721 960 112	0.152	87	65
90		16	721 960 113	0.269	105	77
110		16	721 960 114	0.457	128	94
140	5	10	721 960 116	1.036	164	92
160		10	721 960 117	1.534	188	130
200		10	721 960 119	2.614	230	170
225		10	721 960 120	3.320	257	185
280		10	721 960 122	6.200	318	230
315		6	721 960 123	8.500	356	255



Reducing bush long PVC-U metric

Model:

- With solvent cement spigot and socket metric

d (mm)	d2 (mm)	PN (bar)	Code	Weight (kg)	z (mm)	L (mm)
8	6	16	721 910 323	0.003	15	27
10	6	16	721 910 326	0.003	15	27
10	8	16	721 910 325	0.003	15	27
20	16	16	721 910 334	0.009	21	35
25	20	16	721 910 337	0.014	25	41
32	25	16	721 910 341	0.024	30	49
40	32	16	721 910 346	0.044	36	58
50	40	16	721 910 352	0.074	44	70
63	50	16	721 910 358	0.148	54	85
75	63	16	721 910 364	0.211	62	100
90	75	16	721 910 370	0.335	74	118
140	110	16	721 910 385	0.808	111	172

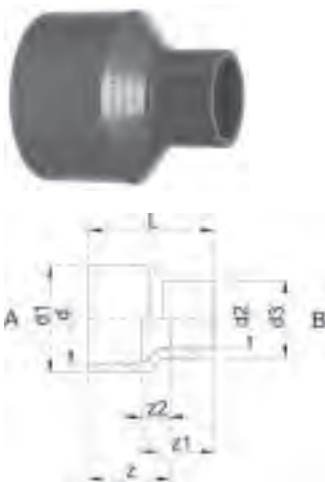

PRO-FIT reducing bush PVC-U metric

Model:

- Outlet: A and B = solvent cemented spigot in combination with reducing socket metric

d (mm)	d1 (mm)	d3 (mm)	PN (bar)	d2 (mm)	Code	Weight (kg)	z (mm)	z1 (mm)	z2 (mm)	L (mm)
10	14	12	16	8	721 910 903	0.003	15	15	3	27
12	16	12	16	8	721 910 905	0.004	18	18	6	30
12	16	16	16	10	721 910 906	0.004	18	18	6	30
16	20	16	16	10	721 910 908	0.003	21	19	7	33
16	20	16	16	12	721 910 909	0.004	21	19	7	33
20	25	16	16	12	721 910 910	0.008	25	21	9	37
20	25	20	16	16	721 910 911	0.008	25	23	9	39
25	32	16	16	12	721 910 912	0.014	30	23	11	42
25	32	20	16	16	721 910 913	0.015	30	26	12	44
25	32	25	16	20	721 910 914	0.017	30	27	11	46
32	40	20	16	16	721 910 915	0.025	36	28	14	50
32	40	25	16	20	721 910 916	0.026	36	30	14	52
32	40	32	16	25	721 910 917	0.031	36	33	14	55
40	50	25	16	20	721 910 918	0.045	44	34	18	60
40	50	32	16	25	721 910 919	0.052	44	37	18	63
40	50	40	16	32	721 910 920	0.058	44	40	18	66
50	63	32	16	25	721 910 921	0.092	54	42	23	73
50	63	40	16	32	721 910 922	0.098	54	45	23	76
50	63	50	16	40	721 910 923	0.111	54	49	23	80
63	75	40	16	32	721 910 924	0.127	62	46	24	84
63	75	50	16	40	721 910 925	0.139	62	50	24	88
63	75	63	16	50	721 910 926	0.167	62	55	24	93
75	90	50	16	40	721 910 927	0.224	74	56	30	100
75	90	63	16	50	721 910 928	0.253	74	61	30	105
75	90	75	16	63	721 910 929	0.265	74	68	30	112



Reducing bush short PVC-U metric

Model:

- With solvent cement spigot and socket metric

	d (mm)	d1 (mm)	PN (bar)	Code	Weight (kg)	z (mm)	L (mm)
*	12	8	16	721 900 329	0.002	2	14
*	16	12	16	721 900 331	0.002	2	14
*	20	16	16	721 900 334	0.002	2	16
*	25	20	16	721 900 337	0.004	3	19
*	32	20	16	721 900 342	0.014	6	22
*	32	25	16	721 900 341	0.009	3	22
	40	20	16	721 900 348	0.021	10	26
	40	25	16	721 900 347	0.021	7	26
*	40	32	16	721 900 346	0.016	4	26
	50	20	16	721 900 355	0.037	15	31
	50	25	16	721 900 354	0.034	12	31
	50	32	16	721 900 353	0.036	9	31
*	50	40	16	721 900 352	0.030	5	31
	63	32	16	721 900 360	0.064	16	38
	63	40	16	721 900 359	0.067	12	38
*	63	50	16	721 900 358	0.058	7	38
	75	50	16	721 900 365	0.109	13	44
*	75	63	16	721 900 364	0.078	6	44
	90	50	16	721 900 372	0.181	20	51
	90	63	16	721 900 371	0.183	13	51
*	90	75	16	721 900 370	0.135	7	51
	110	50	16	721 900 379	0.316	30	61
	110	63	16	721 900 378	0.308	23	61
	110	75	16	721 900 377	0.295	17	61
*	110	90	16	721 900 376	0.259	10	61
	125	90	16	721 900 381	0.465	18	69
*	125	110	16	721 900 380	0.267	8	69
	140	90	16	721 900 386	0.562	25	76
*	140	110	16	721 900 385	0.605	15	76
*	140	125	16	721 900 384	0.331	7	76
	160	90	16	721 900 391	0.751	35	86
	160	110	16	721 900 390	0.883	25	86
*	160	140	16	721 900 388	0.551	10	86
	200	110	10	721 900 393	1.985	45	108
	200	125	10	721 900 325	2.024	37	108
	200	140	10	721 900 394	1.928	29	108
*	200	160	10	721 900 392	1.085	20	108
	225	110	10	721 900 397	2.544	57	120
	225	125	10	721 900 399	2.563	49	120
	225	140	10	721 900 398	2.609	41	120
	225	160	10	721 900 396	2.199	31	119
*	225	200	10	721 900 181	1.360	13	119
	250	125	10	721 900 326	3.150	11	131
	250	140	10	721 900 300	3.200	54	133
	250	160	10	721 900 301	3.390	44	133
*	250	200	10	721 900 302	3.198	24	133
*	250	225	10	721 900 303	1.686	11	133
	280	140	10	721 900 307	4.157	69	148
	280	160	10	721 900 308	4.170	60	148
	280	200	10	721 900 304	4.577	39	148
*	280	225	10	721 900 305	4.409	27	146
*	280	250	10	721 900 306	2.515	14	148
	315	160	6	721 900 313	5.188	77	166
	315	200	6	721 900 309	5.480	57	166
	315	225	6	721 900 310	6.035	44	166
*	315	250	6	721 900 311	6.481	32	166
*	315	280	6	721 900 312	4.055	28	167
	355	315	6	721 900 315	5.792	23	206

table continued on the next page



	d (mm)	d1 (mm)	PN (bar)	Code	Weight (kg)	z (mm)	L (mm)
	400	250	6	721 900 319	11.528	60	206
	400	280	6	721 900 320	11.366	60	206
*	400	315	6	721 900 321	13.006	42	206
*	400	355	6	721 900 322	7.524	22	206

Adaptor fittings

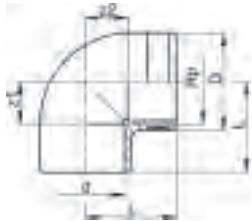

Elbow 90° PVC-U metric Rp

Model:

- With solvent cement socket metric and parallel female thread Rp
- Reinforcing ring stainless (A2)
- Connection to plastic or metal threads
- Install with low mechanical stress and avoid large cyclic temperature changes
- Do not use thread sealing pastes that are harmful to PVC-U

as long as stocks last

d (mm)	Rp (inch)	PN (bar)	Code	Weight (kg)	z1 (mm)	z2 (mm)	D (mm)	L (mm)
12	¼	16	721 100 204	0.010	7	7	20	19
16	⅜	16	721 100 205	0.015	9	9	25	23
20	½	16	721 100 206	0.023	13	11	30	27
25	¾	16	721 100 207	0.035	16	15	35	33
32	1	16	721 100 208	0.060	19	19	45	39
40	1 ¼	16	721 100 209	0.122	23	27	55	50
50	1 ½	16	721 100 210	0.187	27	36	62	58
63	2	16	721 100 211	0.324	33	46	75	73



Tee 90° PVC-U metric Rp

Model:

- With solvent cement socket metric, branch with parallel female thread Rp
- Reinforcing ring stainless (A2)
- Connection to plastic or metal threads
- Install with low mechanical stress and avoid large cyclic temperature changes
- Do not use thread sealing pastes that are harmful to PVC-U

d (mm)	Rp (inch)	PN (bar)	Code	Weight (kg)	z1 (mm)	z2 (mm)	D (mm)	D1 (mm)	L (mm)
12	¼	16	721 200 204	0.015	7	7	17	20	19
16	⅜	16	721 200 205	0.027	9	9	21	25	23
20	½	16	721 200 206	0.029	11	13	26	30	29
25	¾	16	721 200 207	0.043	14	15	32	35	33
32	1	16	721 200 208	0.080	17	19	40	45	39
40	1 ¼	16	721 200 209	0.134	23	26	47	55	49
50	1 ½	16	721 200 210	0.212	27	36	59	59	59
63	2	16	721 200 211	0.379	33	46	74	75	71



Adaptor socket PVC-U metric Rp

Model:

- With solvent cement socket metric and parallel female thread Rp
- Reinforcing ring stainless (A2)
- Connection to plastic or metal threads
- Install with low mechanical stress and avoid large cyclic temperature changes
- Do not use thread sealing pastes that are harmful to PVC-U

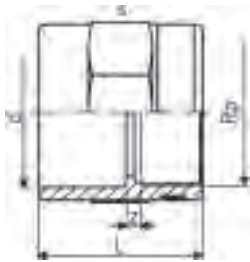

d (mm)	Rp (inch)	PN (bar)	Code	Weight (kg)	z (mm)	L (mm)	s (mm)
12	¼	16	721 910 204	0.010	4	27	22
16	⅜	16	721 910 205	0.016	5	31	27
20	½	16	721 910 206	0.025	5	36	32
25	¾	16	721 910 207	0.032	5	40	36
32	1	16	721 910 208	0.057	5	45	46
40	1 ¼	16	721 910 209	0.087	5	51	55
50	1 ½	16	721 910 210	0.126	7	59	65
63	2	16	721 910 211	0.206	7	69	80



Adaptor socket PVC-U metric Rp

Model:

- With solvent cement socket metric and parallel female thread Rp
- Connection to plastic thread only
- Install with low mechanical stress and avoid large cyclic temperature changes
- Do not use thread sealing pastes that are harmful to PVC-U



d (mm)	Rp (inch)	PN (bar)	Code	Weight (kg)	z (mm)	L (mm)	s (mm)
75	2 ½	10	721 916 012	0.220	7	82	90
90	3	10	721 916 013	0.365	9	94	110
110	4	10	721 916 014	0.536	9	110	130



Adaptor socket PVC-U metric NPT

Model:

- With solvent cement socket metric and NPT (ASTM) taper female thread
- Connection to plastic thread only
- Install with low mechanical stress and avoid large cyclic temperature changes
- Do not use thread sealing pastes that are harmful to PVC-U



d (mm)	NPT (inch)	PN (bar)	Code	Weight (kg)	z (mm)	L (mm)	s (mm)
20	½	10	721 914 206	0.021	5	35	32
25	¾	10	721 914 207	0.028	6	40	36
32	1	10	721 914 208	0.049	6	45	46
40	1 ¼	10	721 914 209	0.076	6	51	55
50	1 ½	10	721 914 210	0.110	10	59	65
63	2	10	721 914 211	0.175	10	69	80



Reducing bush PVC-U metric Rp

Model:

- With solvent cement spigot metric and parallel female thread Rp
- Reinforcing ring stainless (A2)
- Connection to plastic or metal threads
- Install with low mechanical stress and avoid large cyclic temperature changes
- Do not use thread sealing pastes that are harmful to PVC-U

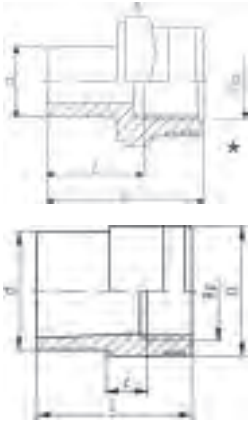

	d (mm)	Rp (inch)	PN (bar)	Code	Weight (kg)	z (mm)	D (mm)	L (mm)	s (mm)
*	12	¼	16	721 910 404	0.008	0	20	27	22
	20	¾	16	721 910 434	0.014	7	25	35	
	25	½	16	721 910 437	0.021	7	30	41	
	32	¾	16	721 910 441	0.032	15	35	48	
	40	1	16	721 910 446	0.058	20	45	56	
	50	1 ¼	16	721 910 452	0.097	20	55	66	
	63	1 ½	16	721 910 458	0.151	10	62	77	



Adaptor bush equal PVC-U metric Rp

Model:

- With solvent cement spigot metric and parallel female thread Rp
- Connection to plastic thread only
- Install with low mechanical stress and avoid large cyclic temperature changes
- Do not use thread sealing pastes that are harmful to PVC-U



d (mm)	Rp (inch)	PN (bar)	Code	Weight (kg)	z (mm)	D (mm)	L (mm)
20	½	10	721 900 406	0.012	22	28	37
25	¾	10	721 900 407	0.018	25	34	41
32	1	10	721 900 408	0.035	29	42	48
40	1 ¼	10	721 900 409	0.063	34	52	56
50	1 ½	10	721 900 410	0.097	40	62	61
63	2	10	721 900 411	0.170	49	77	74



Adaptor socket nipple PVC-U metric R

Model:

- With solvent cement spigot/socket reducing metric and taper male thread R
- Install with low mechanical stress and avoid large cyclic temperature changes
- Do not use thread sealing pastes that are harmful to PVC-U

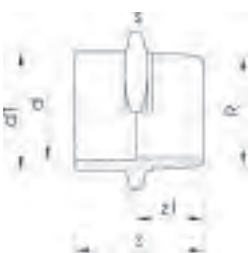

d (mm)	d1 (mm)	R (inch)	PN (bar)	Code	Weight (kg)	z (mm)	z1 (mm)	s (mm)
12	16	¾	16	721 910 555	0.010	35	23	27
16	20	½	16	721 910 556	0.016	42	28	32
20	25	¾	16	721 910 557	0.023	47	31	36
25	32	1	16	721 910 558	0.040	54	35	46
32	40	1 ¼	16	721 910 559	0.061	60	38	55
40	50	1 ½	16	721 910 560	0.094	66	40	65
50	63	2	16	721 910 561	0.164	78	47	80



Adaptor bush equal PVC-U metric R

Model:

- With solvent cement socket metric and taper male thread R
- Install with low mechanical stress and avoid large cyclic temperature changes
- Do not use thread sealing pastes that are harmful to PVC-U

d (inch)	R (inch)	d (mm)	PN (bar)	Code	Weight (kg)	z (mm)	L (mm)	s (mm)
3/8	3/8	16	16	721 910 705	0.011	20	34	27
1/2	1/2	20	16	721 910 706	0.018	24	40	32
3/4	3/4	25	16	721 910 707	0.025	25	44	36
1	1	32	16	721 910 708	0.039	28	50	46
1 1/4	1 1/4	40	16	721 910 709	0.061	31	57	55
1 1/2	1 1/2	50	16	721 910 710	0.092	32	63	65
2	2	63	16	721 910 711	0.161	38	76	80
2 1/2	2 1/2	75	10	721 910 712	0.227	42	86	90
3	3	90	10	721 910 713	0.389	46	97	110
4	4	110	10	721 910 714	0.572	53	114	130



Adaptor nipple PVC-U metric R

Model:

- With solvent cement spigot metric and taper male thread R
- Install with low mechanical stress and avoid large cyclic temperature changes
- Do not use thread sealing pastes that are harmful to PVC-U

d (mm)	R (inch)	PN (bar)	Code	Weight (kg)	z (mm)
16	3/8	10	721 913 505	0.006	31
20	1/2	10	721 913 506	0.010	35
25	3/4	10	721 913 507	0.017	40
32	1	10	721 913 508	0.026	46



Adaptor socket brass/PVC-U metric R

Model:

- Brass with taper male thread R and PVC-U solvent cement socket insert, metric
- Install with low mechanical stress and avoid large cyclic temperature changes

d (mm)	R (inch)	PN (bar)	Code	Weight (kg)	z (mm)	L (mm)	s (mm)
40	1 1/4	16	720 910 709	0.437	36	64	58
50	1 1/2	16	720 910 710	0.671	38	72	70
63	2	16	720 910 711	1.035	43	84	85



Adaptor socket brass/PVC-U metric Rp

Model:

- Brass with parallel female thread Rp and PVC-U solvent cement socket insert, metric
- Install with low mechanical stress and avoid large cyclic temperature changes

d (mm)	Rp (inch)	PN (bar)	Code	Weight (kg)	z (mm)	L (mm)	s (mm)
40	1 ¼	16	720 910 209	0.482	17	66	58
50	1 ½	16	720 910 210	0.737	19	74	70
63	2	16	720 910 211	1.130	19	86	83

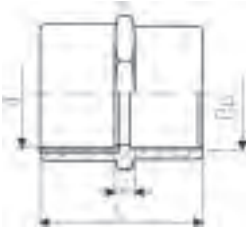

Manometer adaptor sockets PVC-U metric G

Model:

- With solvent cement socket metric and female thread G
- Reinforcing ring stainless (A2)
- Connection to plastic or metal threads
- Do not use thread sealing pastes that are harmful to PVC-U
- Install with low mechanical stress and avoid large cyclic temperature changes

d (mm)	G (inch)	PN (bar)	Code	Weight (kg)	z (mm)	L (mm)	s (mm)
12	¼	16	721 916 204	0.010	4	27	22
16	½	16	721 916 206	0.026	7	36	32



Hose connector PVC-U metric

Model:

- With solvent cement spigot metric and tapered hose connection

d (mm)	PN (bar)	Code	Weight (kg)	d1 (mm)	D (mm)	L (mm)
10	16	721 960 303	0.004	6	12	51
12	16	721 960 304	0.004	6	12	51
16	16	721 960 305	0.007	8	16	57
20	16	721 960 306	0.016	11	22	73





Hose connector PVC-U metric

Model:

- With solvent cement spigot metric and parallel hose connection

d (mm)	PN (bar)	Code	Weight (kg)	D (mm)	L (mm)
10	16	721 960 403	0.002	8	47
12	16	721 960 404	0.003	12	51
16	16	721 960 405	0.008	16	57
20	16	721 960 406	0.016	20	73
25	16	721 960 407	0.021	25	79
32	16	721 960 408	0.035	30	89
40	16	721 960 409	0.060	40	100
50	16	721 960 410	0.112	50	105
63	16	721 960 411	0.180	60	120

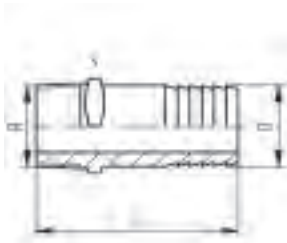

Hose connector PVC-U R

Model:

- With taper male thread R
- With parallel hose connector
- Do not use thread sealing pastes that are harmful to PVC-U

R (inch)	PN (bar)	Code	Weight (kg)	D (mm)	L (mm)	s (mm)
¼	10	721 960 704	0.003	12	59	14
⅜	10	721 960 705	0.006	16	67	19
½	10	721 960 706	0.019	20	86	22
¾	10	721 960 707	0.026	25	92	27
1	10	721 960 708	0.048	30	103	36
1 ¼	10	721 960 709	0.079	40	115	46

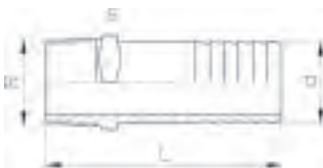

Hose connector PVC-U R reduced

Model:

- With taper male thread R
- With parallel hose connector
- Connection to plastic thread only
- Do not use thread sealing pastes that are harmful to PVC-U

R (inch)	Code	Weight (kg)	s (mm)	d (mm)	L (mm)
½	721 961 706	0.012	22	14	70
¾	721 961 707	0.021	27	20	80
1	721 961 708	0.042	36	27	90



Adaptor fitting PVC-U metric - Victaulic

Model:

- With solvent cement spigot and socket metric
- For metal couplings (type Victaulic)



d (mm)	d1 (mm)	d2 (inch)	PN (bar)	Code	Weight (kg)	L (mm)	z (mm)
50	40	1 ½	10	721 910 090	0.150	71	45
63	50	2	10	721 910 091	0.200	78	47
75	63	2 ½	10	721 910 092	0.250	84	46



Adaptor fitting PVC-U/stainless steel

Model:

- Stainless steel WN 1.4404 (3162) with taper male thread R
- Gasket: O-ring EPDM

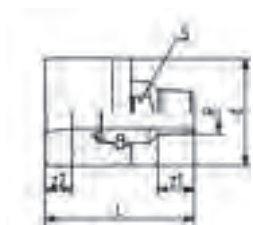

d (mm)	R (inch)	PN (bar)	Code	Weight (kg)	z1 (mm)	z2 (mm)	L (mm)	S (mm)
40	½	10	721 940 631	0.335	17.0	12.4	63.2	25
50	½	10	721 940 632	0.402	17.0	12.5	69.2	25
50	¾	10	721 940 633	0.414	18.5	13.0	72.9	30
63	½	10	721 940 634	0.521	17.0	7.1	81.2	25
63	¾	10	721 940 635	0.533	18.5	13.0	84.9	30
63	1	10	721 940 636	0.542	21.5	18.9	89.7	36



Adaptor fitting PVC-U/stainless steel

Model:

- Stainless steel WN 1.4404 (316L) with parallel female thread Rp
- Gasket: O-ring EPDM



d (mm)	Rp (inch)	PN (bar)	Code	Weight (kg)	z1 (mm)	z2 (mm)	L (mm)	S (mm)
40	½	10	721 940 131	0.267	17.0	12.4	63.2	25
50	½	10	721 940 132	0.345	17.0	12.5	69.2	25
50	¾	10	721 940 133	0.352	18.5	13.0	72.9	30
63	½	10	721 940 134	0.432	17.0	7.1	81.2	25
63	¾	10	721 940 135	0.441	18.5	13.0	84.9	30
63	1	10	721 940 136	0.453	21.5	18.9	89.7	36

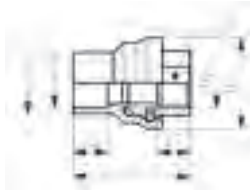

Adaptor Fitting PVC-U/stainless steel Rp

Model:

- Adaptor fitting equally suitable as socket and spigot
- Stainless steel WN 1.4404 (316L) with parallel female thread Rp
- Gasket: O-ring EPDM

d (mm)	D (mm)	PN (bar)	Rp (inch)	Code	Weight (kg)	z1 (mm)	z2 (mm)	D1 (mm)	L (mm)	S (mm)
20	25	16	½	721 940 106	0.095	17	17	40	70	25
25	32	16	¾	721 940 107	0.171	19	19	50	83	30
32	40	16	1	721 940 108	0.262	22	23	59	96	36



Adaptor Fitting PVC-U/stainless steel R

Model:

- Adaptor fitting equally suitable as socket and spigot
- Stainless steel with taper male thread R
- Gasket: O-ring EPDM

PN (bar)	D (mm)	R (inch)	d (mm)	Code	Weight (kg)	D1 (mm)	S (mm)	z2 (mm)	z1 (mm)	L (mm)
16	25	½	20	721 940 606	0.120	40	25	17	17	70
16	32	¾	25	721 940 607	0.213	50	30	19	19	83
16	40	1	32	721 940 608	0.320	59	36	23	22	96



Adaptor fitting PVC-U/brass

Model:

- Brass with parallel female thread Rp
- Gasket: O-ring EPDM

d (mm)	Rp (inch)	PN (bar)	Code	Weight (kg)	z1 (mm)	z2 (mm)	L (mm)	S (mm)
40	½	10	721 950 131	0.279	17.0	12.4	48.2	25
50	½	10	721 950 132	0.355	17.0	12.5	54.2	25
50	¾	10	721 950 133	0.362	18.5	13.0	54.9	30
63	½	10	721 950 134	0.526	17.0	7.1	66.2	25
63	¾	10	721 950 135	0.531	18.5	13.0	66.9	30
63	1	10	721 950 136	0.542	21.5	18.9	70.7	36

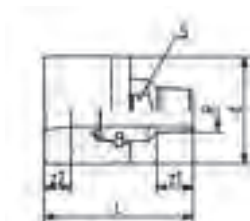

Adaptor fitting PVC-U/brass

Model:

- Brass with taper male thread R
- Gasket: O-ring EPDM

d (mm)	R (inch)	PN (bar)	Code	Weight (kg)	z1 (mm)	z2 (mm)	L (mm)	S (mm)
40	½	10	721 950 631	0.352	17.0	12.4	63.2	25
50	½	10	721 950 632	0.438	17.0	12.5	69.2	25
50	¾	10	721 950 633	0.442	18.5	13.0	72.9	30
63	½	10	721 950 634	0.498	17.0	7.1	81.2	25
63	¾	10	721 950 635	0.512	18.5	13.0	84.9	30
63	1	10	721 950 636	0.521	21.5	18.9	89.7	36



Adaptor Fitting PVC-U/brass Rp

Model:

- Adaptor fitting equally suitable as socket and spigot
- Brass with parallel female thread Rp
- Gasket: O-ring EPDM

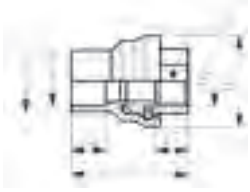

d (mm)	D (mm)	PN (bar)	Rp (inch)	Code	Weight (kg)	z1 (mm)	z2 (mm)	D1 (mm)	L (mm)	S (mm)
20	25	16	½	721 950 106	0.098	17.0	16.5	40	54.5	25
25	32	16	¾	721 950 107	0.181	18.5	19.0	50	65.2	30
32	40	16	1	721 950 108	0.270	21.5	22.5	59	76.5	36



Adaptor Fitting PVC-U/brass R

Model:

- Adaptor fitting equally suitable as socket and spigot
- Brass with taper male thread R
- Gasket: O-ring EPDM



d (mm)	D (mm)	PN (bar)	R (inch)	Code	Weight (kg)	z1 (mm)	z2 (mm)	D1 (mm)	L (mm)	S (mm)
20	25	16	½	721 950 606	0.129	17	17	40	70	25
25	32	16	¾	721 950 607	0.232	19	19	50	83	30
32	40	16	1	721 950 608	0.390	22	23	59	96	36

Threaded fittings



Elbow 90° PVC-U Rp

Model:

- With parallel female thread Rp
- Connection to plastic thread only
- Install with low mechanical stress and avoid large cyclic temperature changes
- Do not use thread sealing pastes that are harmful to PVC-U

Rp (inch)	PN (bar)	Code	Weight (kg)	z (mm)	D (mm)	L (mm)
3/8	10	721 101 605	0.013	9	23	23
1/2	10	721 101 606	0.017	12	27	27
3/4	10	721 101 607	0.029	15	33	33
1	10	721 101 608	0.042	19	39	39
1 1/4	10	721 101 609	0.070	27	48	49
1 1/2	10	721 101 610	0.178	35	61	59
2	10	721 101 611	0.322	44	75	72



Tee 90° equal PVC-U Rp

Model:

- With parallel female thread Rp
- Connection to plastic thread only
- Install with low mechanical stress and avoid large cyclic temperature changes
- Do not use thread sealing pastes that are harmful to PVC-U

Rp (inch)	PN (bar)	Code	Weight (kg)	z (mm)	D (mm)	L (mm)
3/8	10	721 201 605	0.016	9	23	23
1/2	10	721 201 606	0.027	12	28	27
3/4	10	721 201 607	0.039	15	33	33
1	10	721 201 608	0.072	19	41	39
1 1/4	10	721 201 609	0.146	27	50	49
1 1/2	10	721 201 610	0.267	36	62	60
2	10	721 201 611	0.485	44	77	72



Socket PVC-U Rp

Model:

- With parallel female thread Rp
- Connection to plastic thread only
- Do not use thread sealing pastes that are harmful to PVC-U
- Install with low mechanical stress and avoid large cyclic temperature changes

Rp (inch)	PN (bar)	Code	Weight (kg)	z (mm)	L (mm)	s (mm)
1/4	10	721 910 604	0.010	7	27	22
3/8	10	721 910 605	0.015	7	29	27
1/2	10	721 910 606	0.024	9	35	32
3/4	10	721 910 607	0.029	9	39	36
1	10	721 910 608	0.053	11	45	46
1 1/4	10	721 910 609	0.076	11	49	55
1 1/2	10	721 910 610	0.106	11	49	65
2	10	721 910 611	0.180	11	57	80



Reducing bush PVC-U R Rp

Model:

- With taper male thread R and parallel female thread Rp
- Connection to plastic thread only
- Install with low mechanical stress and avoid large cyclic temperature changes
- Do not use thread sealing pastes that are harmful to PVC-U

R (inch)	Rp (inch)	PN (bar)	Code	Weight (kg)	z (mm)	L (mm)	s (mm)
½	¾	10	721 910 834	0.014	25	36	27
¾	½	10	721 910 837	0.021	25	39	32
1	½	10	721 910 842	0.029	31	45	32
1	¾	10	721 910 841	0.031	29	45	36
1 ¼	1	10	721 910 846	0.050	32	50	46
1 ½	1 ¼	10	721 910 852	0.065	35	55	55
2	1 ½	10	721 910 858	0.127	45	65	65

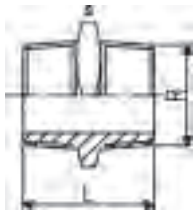

Threaded nipple R PVC-U

Model:

- With taper male thread R
- Install with low mechanical stress and avoid large cyclic temperature changes
- Do not use thread sealing pastes that are harmful to PVC-U

R (inch)	PN (bar)	Type	Code	Weight (kg)	L (mm)	s (mm)
¾	10	A	721 911 905	0.007	37	19
½	10	A	721 911 906	0.012	45	22
¾	10	A	721 911 907	0.019	49	27
1	10	A	721 911 908	0.034	57	36
1 ¼	10	A	721 911 909	0.052	62	46
1 ½	10	A	721 911 910	0.070	67	50
2	10	A	721 911 911	0.126	76	65



Cap PVC-U Rp

Model:

- With parallel female thread Rp
- Connection to plastic thread only
- Install with low mechanical stress and avoid large cyclic temperature changes
- Do not use thread sealing pastes that are harmful to PVC-U

Rp (inch)	PN (bar)	Code	Weight (kg)	D (mm)	L (mm)	s (mm)
¾	10	721 960 603	0.013	20	14	17
¾	10	721 960 604	0.024	25	16	22
¾	10	721 960 605	0.012	31	19	27
½	10	721 960 606	0.018	37	21	32
¾	10	721 960 607	0.024	42	24	36
1	10	721 960 608	0.040	50	26	46
1 ¼	10	721 960 609	0.060	60	29	55
1 ½	10	721 960 610	0.072	65	31	60
2	10	721 960 611	0.127	81	36	75



Plug PVC-U G

Model:

- With parallel male thread G
- Connection to plastic thread only
- Flat gasket necessary for sealing
- Install with low mechanical stress and avoid large cyclic temperature changes
- Do not use thread sealing pastes that are harmful to PVC-U



G (inch)	PN (bar)	Code	Weight (kg)	L (mm)	s (mm)
3/8	10	721 960 905	0.005	21	22
1/2	10	721 960 906	0.010	25	27
3/4	10	721 960 907	0.018	29	36
1	10	721 960 908	0.029	32	41
1 1/4	10	721 960 909	0.048	36	50
1 1/2	10	721 960 910	0.070	37	60
2	10	721 960 911	0.120	42	75



Plug PVC-U R

Model:

- With taper male thread R
- Install with low mechanical stress and avoid large cyclic temperature changes
- Do not use thread sealing pastes that are harmful to PVC-U



R (inch)	PN (bar)	Code	Weight (kg)	L (mm)	s (mm)
3/8	10	721 961 905	0.006	21	22
1/2	10	721 961 906	0.011	25	27
3/4	10	721 961 907	0.020	29	36
1	10	721 961 908	0.030	32	41
1 1/4	10	721 961 909	0.048	36	50
1 1/2	10	721 961 910	0.071	37	60
2	10	721 961 911	0.119	42	75

Unions



Union for solvent cement jointing PVC-U metric

Model:

- Union End: solvent socket metric
- Union Bush: Solvent socket metric
- Gasket: O-ring EPDM code no. 748 410 004-016; d90 748 410 248
- Jointing face: With O-ring groove

d (mm)	d (inch)	PN (bar)	EPDM Code	Weight (kg)	FPM Code	Weight (kg)
10		16	721 510 103	0.021	721 510 128	0.020
12		16	721 510 104	0.020	721 510 129	0.019
16		16	721 510 105	0.025	721 510 130	0.025
20		16	721 510 106	0.041	721 510 131	0.042
25		16	721 510 107	0.058	721 510 132	0.058
32		16	721 510 108	0.083	721 510 133	0.084
40		16	721 510 109	0.147	721 510 134	0.152
50		16	721 510 110	0.203	721 510 135	0.207
63		16	721 510 111	0.356	721 510 136	0.361
75	2 ½	10	721 510 112	0.614	721 510 137	0.621
90		10	721 510 313	0.920	721 510 338	0.929
110		10	721 510 114	1.434	721 510 139	1.492

d (mm)	z1 (mm)	z2 (mm)	D (mm)	L1 (mm)	L2 (mm)	G/Tr (inch)
10	3	10	31	15	22	5/8
12	3	10	31	15	22	5/8
16	3	10	35	17	24	3/4
20	3	10	43	19	26	1
25	3	10	51	22	29	1 1/4
32	3	10	58	25	33	1 1/2
40	3	12	72	29	39	2
50	3	14	83	34	46	2 1/4
63	3	18	100	41	58	2 3/4
75	3	18	135	47	62	Tr108x5
90	5	18	158	56	69	Tr128x5
110	5	11	188	66	72	Tr154x6



PRO-FIT union PVC-U metric

Model:

- Union End: Solvent cemented spigot in combination with reducing socket metric
- Union Bush: Solvent socket metric
- Gasket: O-ring EPDM code no. 748 410 005-011

d (mm)	d1 (mm)	PN (bar)	EPDM Code	Weight (kg)	FPM Code	Weight (kg)	
*	16	12	16	721 510 305	0.029	721 510 330	0.029
*	20	16	16	721 510 306	0.046	721 510 331	0.044
*	25	20	16	721 510 307	0.073	721 510 332	0.073
*	32	25	16	721 510 308	0.097	721 510 333	0.095
	40	32	16	721 510 309	0.169	721 510 334	0.171
	50	40	16	721 510 310	0.250	721 510 335	0.250
	63	50	16	721 510 311	0.437	721 510 336	0.449

d (mm)	G (inch)	z1 (mm)	z2 (mm)	z3 (mm)	D (mm)	L1 (mm)	L2 (mm)	
*	16	¾	22	10	24	35	36	24
*	20	1	24	10	26	43	40	26
*	25	1 ¼	25	10	28	51	44	29

table continued on the next page



	d	G	z1	z2	z3	D	L1	L2
	(mm)	(inch)	(mm)	(mm)	(mm)	(mm)	(mm)	(mm)
*	32	1 ½	27	10	30	58	49	33
	40	2	31	12	35	74	57	39
	50	2 ¼	35	14	40	83	66	46
	63	2 ¾	39	18	46	100	77	58



Adaptor union PVC-U metric Inch BS

Model:

- Union End: Solvent cement socket metric
- Union Bush: Solvent cement socket BS inch
- Gasket: O-ring EPDM code no. 748 410 005-011
- Gasket: O-ring FPM code no. 749 410 005-011 (to be ordered separately)

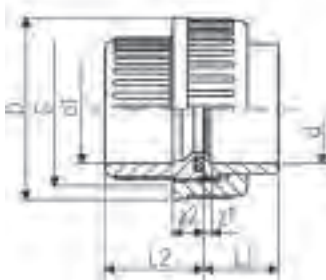

PN	d	d1	Code	Weight	G	z1	z2	D	L1	L2
(bar)	(mm)	(inch)		(kg)	(inch)	(mm)	(mm)	(mm)	(mm)	(mm)
15	16	¾	721 513 105	0.025	¾	3	8	35	17	24
15	20	½	721 513 106	0.040	1	3	9	43	19	26
15	25	¾	721 513 107	0.065	1 ¼	3	9	51	22	29
15	32	1	721 513 108	0.090	1 ½	3	9	58	25	33
15	40	1 ¼	721 513 109	0.155	2	3	10	72	29	39
15	50	1 ½	721 513 110	0.200	2 ¼	3	10	83	34	46
15	63	2	721 513 111	0.341	2 ¾	3	10	100	41	58



Union for solvent cement jointing PVC-U metric/ASTM

Model:

- Union End: Solvent cement socket ASTM
- Union Bush: Solvent socket metric
- Gasket: O-ring EPDM code no. 748 410 005-011
- Gasket: O-ring FPM code no. 749 410 005-011 (to be ordered separately)

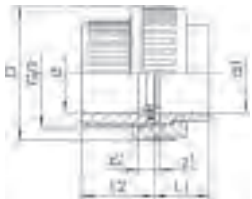

d	d1	PN	Code	Weight	G	z1	z2	D	L1	L2
(mm)	(inch)	(bar)		(kg)	(inch)	(mm)	(mm)	(mm)	(mm)	(mm)
16	¾	16	721 514 105	0.022	¾	3	10	35	22	24
20	½	16	721 514 106	0.042	1	3	10	43	25	26
25	¾	16	721 514 107	0.065	1 ¼	3	10	51	28	29
32	1	16	721 514 108	0.103	1 ½	3	10	58	32	33
40	1 ¼	16	721 514 109	0.174	2	3	12	72	35	39
50	1 ½	16	721 514 110	0.239	2 ¼	3	14	83	38	46
63	2	16	721 514 111	0.356	2 ¾	3	18	100	41	58



Union with union end blank PVC-U metric

Model:

- Union Bush: Solvent socket metric
- Jointing face: With O-ring groove

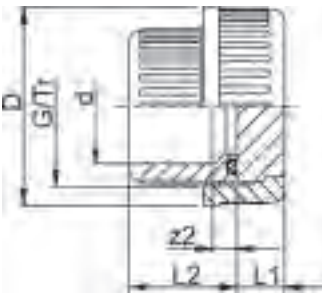

d (mm)	PN (bar)	EPDM Code	Weight (kg)	FPM Code	Weight (kg)	z2 (mm)	L2 (mm)	D (mm)	L1 (mm)	G/Tr (inch)
10	16	721 510 003	0.020	721 510 028	0.020	9	22	31	10	5/8
12	16	721 510 004	0.020	721 510 029	0.020	9	22	31	15	5/8
16	16	721 510 005	0.026	721 510 030	0.026	10	24	35	10	3/4
20	16	721 510 006	0.041	721 510 031	0.041	10	26	43	11	1
25	16	721 510 007	0.068	721 510 032	0.068	10	29	51	11	1 1/4
32	16	721 510 008	0.095	721 510 033	0.095	10	33	58	12	1 1/2
40	16	721 510 009	0.159	721 510 034	0.159	12	39	72	13	2
50	16	721 510 010	0.227	721 510 035	0.227	14	46	83	16	2 1/4
63	16	721 510 011	0.392	721 510 036	0.405	18	58	100	18	2 3/4
75	10	721 510 012	0.679	721 510 037	0.693	18	62	135	22	Tr108x5
90	10	721 510 213	1.022	721 510 238	1.022	18	69	158	24	Tr128x5
110	10	721 510 014	1.556	721 510 039	1.573	11	72	188	26	Tr154x6



Adaptor union PVC-U metric Rp

Model:

- Union End: Solvent cement socket metric
- Union Bush: Parallel female thread Rp
- Gasket: O-ring EPDM code no. 748 410 004-011
- Gasket: O-ring FPM code no. 749 410 004-011 (to be ordered separately)
- Connection to plastic thread only
- Do not use thread sealing pastes that are harmful to PVC-U

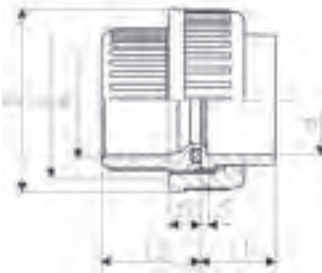

d (mm)	Rp (inch)	PN (bar)	EPDM Code	Weight (kg)	G (inch)	z1 (mm)	z2 (mm)	D (mm)	L1 (mm)	L2 (mm)
12	1/4	10	721 510 204	0.019	5/8	3	12	31	15	22
16	3/8	10	721 510 205	0.020	3/4	3	13	35	17	24
20	1/2	10	721 510 206	0.040	1	3	13	43	19	26
25	3/4	10	721 510 207	0.057	1 1/4	3	14	51	22	29
32	1	10	721 510 208	0.084	1 1/2	3	15	58	25	33
40	1 1/4	10	721 510 209	0.147	2	3	19	72	29	39
50	1 1/2	10	721 510 210	0.218	2 1/4	3	26	83	34	46
63	2	10	721 510 211	0.383	2 3/4	3	33	100	41	58



PRO-FIT adaptor union PVC-U metric Rp

Model:

- Union End: Solvent cemented spigot in combination with reducing socket metric
- Union Bush: Threaded socket with parallel female thread Rp
- Gasket: O-ring EPDM code no. 748 410 005-011
- Gasket: O-ring FPM code no. 749 410 005-011 (to be ordered separately)
- Connection to plastic thread only
- Do not use thread sealing pastes that are harmful to PVC-U

	d (mm)	d1 (mm)	Rp (inch)	PN (bar)	EPDM Code	Weight (kg)	G (inch)	z1 (mm)	z2 (mm)	z3 (mm)	D (mm)	L1 (mm)	L2 (mm)
*	16	12	3/8	10	721 510 405	0.032	3/8	22	13	24	35	36	24
*	20	16	1/2	10	721 510 406	0.046	1	24	13	26	43	40	26
*	25	20	3/4	10	721 510 407	0.079	1 1/4	25	14	28	51	44	29
*	32	25	1	10	721 510 408	0.116	1 1/2	27	15	30	58	49	32
	40	32	1 1/4	10	721 510 409	0.192	2	31	19	35	74	57	38
	50	40	1 1/2	10	721 510 410	0.263	2 1/4	35	26	40	83	66	45
	63	50	2	10	721 510 411	0.496	2 3/4	39	33	46	100	77	56

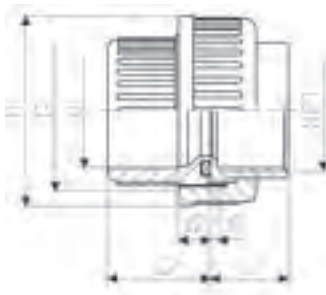

Adaptor union PVC-U metric NPT

Model:

- Union End: Taper female thread NPT (ASTM)
- Union Bush: Solvent socket metric
- Gasket: O-ring EPDM code no. 748 410 005-011
- Gasket: O-ring FPM code no. 749 410 005-011 (to be ordered separately)
- Connection to plastic thread only
- Do not use thread sealing pastes that are harmful to PVC-U

	d (mm)	NPT (inch)	PN (bar)	EPDM Code	Weight (kg)	G (inch)	z1 (mm)	z2 (mm)	D (mm)	L1 (mm)	L2 (mm)
	16	3/8	10	721 514 205	0.026	3/8	4	10	35	17	24
	20	1/2	10	721 514 206	0.042	1	2	10	43	19	26
	25	3/4	10	721 514 207	0.068	1 1/4	4	10	51	22	29
	32	1	10	721 514 208	0.093	1 1/2	4	10	58	25	33
	40	1 1/4	10	721 514 209	0.150	2	6	12	72	29	39
	50	1 1/2	10	721 514 210	0.228	2 1/4	11	14	83	34	46
	63	2	10	721 514 211	0.387	2 3/4	17	18	100	41	58



Adaptor union PVC-U/stainless steel metric Rp

Model:

- Union Nut: PVC-U
- Union Bush: Solvent cement socket PVC-U metric
- Union End: Stainless Steel 1.4404 (316L), parallel female thread Rp
- Gasket: O-ring EPDM code no. 748 410 005-011

Rp (inch)	d (mm)	PN (bar)	EPDM Code	Weight (kg)	FPM Code	Weight (kg)
3/8	16	16	721 540 205	0.053	721 540 230	0.053
1/2	20	16	721 540 206	0.096	721 540 231	0.096
3/4	25	16	721 540 207	0.154	721 540 232	0.134
1	32	16	721 540 208	0.212	721 540 233	0.212
1 1/4	40	16	721 540 209	0.356	721 540 234	0.343
1 1/2	50	16	721 540 210	0.455	721 540 235	0.455
2	63	16	721 540 211	0.730	721 540 236	0.721

table continued on the next page

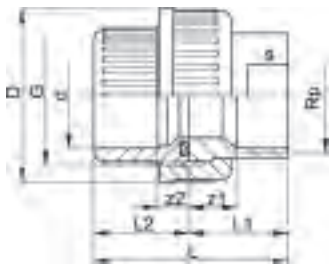

G	z1	z2	D	L	L1	L2	s
(inch)	(mm)	(mm)	(mm)	(mm)	(mm)	(mm)	(mm)
¾	9	10	35	43	19	24	19
1	11	10	43	50	24	26	24
1 ¼	11	10	51	55	26	29	29
1 ½	12	10	58	61	29	33	36
2	14	12	72	71	33	39	45
2 ¼	15	14	83	79	34	46	54
2 ½	15	18	100	95	39	58	63

Adaptor union PVC-U/stainless steel metric R

Model:

- Union Nut: PVC-U
- Union Bush: Solvent cement socket PVC-U metric
- Union End: Stainless Steel 1.4404 (316L), taper male thread R
- Gasket: O-ring EPDM code no. 748 410 005-011

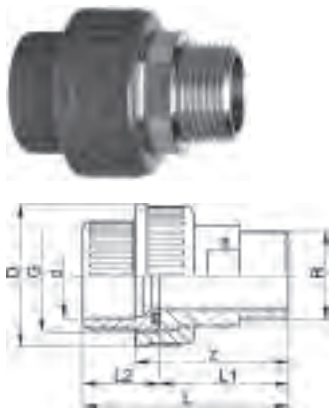

d	R	PN	EPDM	Weight	FPM	Weight
(mm)	(inch)	(bar)	Code	(kg)	Code	(kg)
16	¾	16	721 540 705	0.073	721 540 730	0.073
20	½	16	721 540 706	0.126	721 540 731	0.126
25	¾	16	721 540 707	0.174	721 540 732	0.170
32	1	16	721 540 708	0.262	721 540 733	0.262
40	1 ¼	16	721 540 709	0.476	721 540 734	0.472
50	1 ½	16	721 540 710	0.535	721 540 735	0.535
63	2	16	721 540 711	0.934	721 540 736	0.931

d	G	z	D	L	L1	L2	s
(mm)	(inch)	(mm)	(mm)	(mm)	(mm)	(mm)	(mm)
16	¾	40	35	54	30	24	19
20	1	44	43	60	34	26	24
25	1 ¼	46	51	65	36	29	32
32	1 ½	50	58	72	40	33	37
40	2	58	72	84	46	39	48
50	2 ¼	62	83	93	48	46	54
63	2 ¾	73	100	111	55	58	69

Adaptor union PVC-U/stainless steel metric Welding end

Model:

- Union Bush: Solvent cement socket PVC-U metric
- Union End: Stainless Steel 1.4404 (316L) with welding end
- Union Nut: Stainless Steel WN 1.4404 (316L)
- Gasket: O-ring EPDM code no. 748 410 005-011

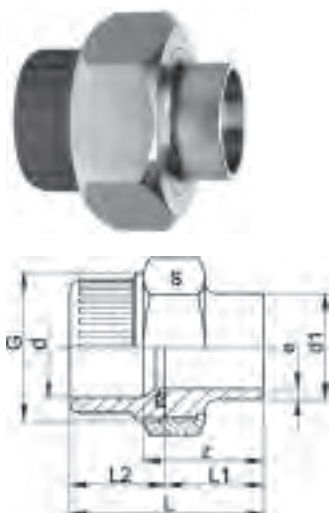

d	d1	PN	EPDM	Weight	FPM	Weight
(mm)	(mm)	(bar)	Code	(kg)	Code	(kg)
16	17	16	721 545 505	0.101	721 545 530	0.101
20	21	16	721 545 506	0.176	721 545 531	0.168
25	27	16	721 545 507	0.204	721 545 532	0.198
32	34	16	721 545 508	0.313	721 545 533	0.313
40	42	16	721 545 509	0.493	721 545 534	0.493
50	48	16	721 545 510	0.566	721 545 535	0.605
63	60	16	721 545 511	0.902	721 545 536	0.902

table continued on the next page



d	G	z	L	L1	L2	e	s
(mm)	(inch)	(mm)	(mm)	(mm)	(mm)	(mm)	(mm)
16	¾	28	42	18	24	1.6	32
20	1	32	48	22	26	2.0	41
25	1 ¼	33	52	23	29	2.0	46
32	1 ½	36	58	26	33	2.0	55
40	2	38	64	26	39	2.0	68
50	2 ¼	42	73	28	46	2.0	74
63	2 ½	50	88	32	58	2.6	88

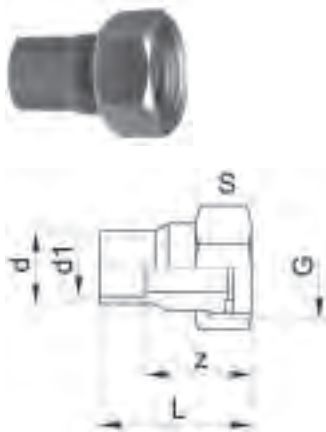

Tap connectors PVC-U/brass metric G

Model:

- Union End: PVC-U, solvent cement socket / spigot metric
- Union Nut: brass with female thread G
- Gasket: flat gasket EPDM code no. 748 400 030; 748 400 005-006

d	d1	G	PN	Code	Weight	z	L	s
(mm)	(mm)	(inch)	(bar)		(kg)	(mm)	(mm)	(mm)
16	12	½	16	721 550 305	0.031	22	34	24
20	16	¾	16	721 550 306	0.049	24	38	30
25	20	1	16	721 550 307	0.079	27	43	38



Adaptor union PVC-U/brass metric Rp

Model:

- Union Nut: PVC-U
- Union bush: Solvent cement socket metric
- Union End: Brass with parallel female thread Rp
- Gasket: O-ring EPDM code no. 748 410 006-014; d90 748 410 248

d	Rp	PN	Code	Weight	D	L	L1	L2	s	z1	z2	G
(mm)	(inch)	(bar)		(kg)	(mm)	(mm)	(mm)	(mm)	(mm)	(mm)	(mm)	(inch)
20	½	16	721 550 506	0.088	43	48	22	26	25	7	10	1
25	¾	16	721 550 507	0.145	51	54	25	29	30	9	10	1 1/4
32	1	16	721 550 508	0.175	58	60	27	33	36	8	11	1 1/2
40	1 ¼	16	721 550 509	0.322	72	70	31	39	46	10	13	2
50	1 ½	16	721 550 510	0.467	83	81	35	46	55	13	15	2 1/4
63	2	16	721 550 511	0.776	100	98	40	58	65	14	20	2 3/4
75	2 ½	10	721 550 512	1.360	127	109	47	62	85	16	18	Tr 108x5
90	3	10	721 550 513	2.003	150	121	52	69	95	18	18	Tr 128x5

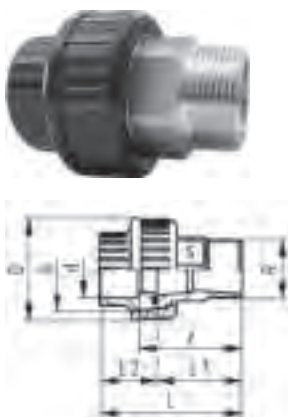

Adaptor union PVC-U/brass metric R

Model:

- Union Nut: PVC-U
- Union Bush: Solvent cement socket PVC-U metric
- Union End: Brass with taper male thread R
- Gasket: O-ring EPDM code no. 748 410 006-014; d90 748 410 248

d	R	PN	Code	Weight	D	L	L1	L2	z	G	s
(mm)	(inch)	(bar)		(kg)	(mm)	(mm)	(mm)	(mm)	(mm)	(inch)	(mm)
20	½	16	721 550 906	0.125	43	63	37	26	47	1	25
25	½	16	721 550 957	0.196	51	66	37	29	47	1 1/4	30
25	¾	16	721 550 907	0.196	51	71	42	29	52	1 1/4	30
25	1	16	721 550 967	0.307	51	75	46	29	56	1 1/4	30

table continued on the next page



d	R	PN	Code	Weight	D	L	L1	L2	z	G	s
(mm)	(inch)	(bar)		(kg)	(mm)	(mm)	(mm)	(mm)	(mm)	(inch)	(mm)
32	1/2	16	721 550 958	0.297	58	70	37	33	48	1 1/2	36
32	3/4	16	721 550 968	0.297	58	75	42	33	53	1 1/2	36
32	1	16	721 550 908	0.283	58	79	46	33	57	1 1/2	36
40	1 1/4	16	721 550 909	0.502	72	91	52	39	65	2	46
50	1 1/2	16	721 550 910	0.681	83	102	56	46	71	2 1/4	55
63	2	16	721 550 911	1.101	100	125	67	58	87	2 3/4	65
75	2 1/2	10	721 550 912	1.706	127	139	77	62	95	Tr 108x5	85
90	3	10	721 550 913	2.662	150	155	86	69	104	Tr 125x8	95



Adaptor union PVC-U/malleable iron galvanised metric Rp

Model:

- Union Nut: PVC-U
- Union Bush: Solvent cement socket PVC-U metric
- Union End: malleable iron with parallel female thread Rp
- Gasket: O-ring EPDM code no. 748 410 006-014; d90 748 410 248

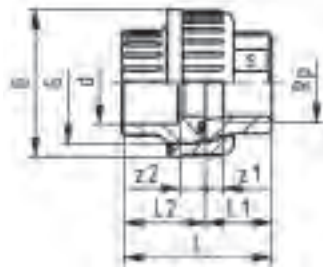

d	Rp	PN	Code	Weight	D	L	L1	L2	z1	z2	G	s
(mm)	(inch)	(bar)		(kg)	(mm)	(mm)	(mm)	(mm)	(mm)	(mm)	(inch)	(mm)
20	1/2	16	721 530 306	0.073	43	48	22	26	9	10	1	25
25	3/4	16	721 530 307	0.107	51	51	22	29	7	10	1 1/4	31
32	1	16	721 530 308	0.154	58	58	26	33	9	10	1 1/2	38
40	1 1/4	16	721 530 309	0.282	72	69	31	39	12	12	2	48
50	1 1/2	16	721 530 310	0.377	83	78	33	46	14	14	2 1/4	54
63	2	16	721 530 311	0.594	100	91	35	58	11	18	2 3/4	67
75	2 1/2	10	721 530 312	1.008	127	101	39	62	12	18	Tr 108x5	85
90	3	10	721 530 313	1.350	150	114	45	69	15	19	Tr 128x5	96



Adaptor union PVC-U/malleable iron galvanised metric R

Model:

- Union Nut: PVC-U
- Union Bush: Solvent cement socket PVC-U metric
- Union End: Malleable iron with taper male thread R
- Gasket: O-ring EPDM code no. 748 410 006-014; d90 748 410 248



d	R	PN	Code	Weight	D	L	L1	L2	z	G	s
(mm)	(inch)	(bar)		(kg)	(mm)	(mm)	(mm)	(mm)	(mm)	(inch)	(mm)
20	1/2	16	721 530 806	0.107	43	66	40	26	50	1	25
25	3/4	16	721 530 807	0.159	51	72	43	29	53	1 1/4	31
32	1	16	721 530 808	0.213	58	80	48	33	58	1 1/2	38
40	1 1/4	16	721 530 809	0.426	72	95	57	39	69	2	48
50	1 1/2	16	721 530 810	0.528	83	104	59	46	73	2 1/4	54
63	2	16	721 530 811	0.863	100	118	62	58	80	2 3/4	67
75	2 1/2	10	721 530 812	1.441	127	137	75	62	93	Tr 108x5	85
90	3	10	721 530 813	1.873	150	149	80	69	99	Tr 128x5	96



Thread union PVC-U Rp Rp

Model:

- Union Nut: PVC-U
- Union Bush: Parallel female thread Rp
- Union End: Parallel female thread Rp
- Connection to plastic thread only
- Do not use thread sealing pastes that are harmful to PVC-U
- Gasket: O-ring EPDM code no. 748 410 004-011
- Gasket: O-ring FPM code no. 749 410 004-011 (to be ordered separately)

Rp (inch)	PN (bar)	Code	Weight (kg)	G (inch)	z1 (mm)	z2 (mm)	D (mm)	L1 (mm)	L2 (mm)
¼	10	721 510 604	0.019	⅝	3	12	31	22	15
⅜	10	721 510 605	0.027	¾	3	13	35	24	17
½	10	721 510 606	0.042	1	3	13	43	26	19
¾	10	721 510 607	0.065	1 ¼	3	14	51	29	22
1	10	721 510 608	0.093	1 ½	3	15	58	32	25
1 ¼	10	721 510 609	0.160	2	3	19	72	38	29
1 ½	10	721 510 610	0.220	2 ¼	3	26	83	45	34
2	10	721 510 611	0.415	2 ¾	3	33	100	56	41



Tank adaptor type 050 PVC-U Compact metric

Model:

- End connection: solvent cement socket, metric
- Gasket: flat gasket EPDM
- Washer: PP
- Run-out holes: two holes in octagonal head
- FPM flat gasket available for tank adaptor type 050

d (mm)	PN (bar)	EPDM Code	Weight (kg)
16	16	161 050 445	0.048
20	16	161 050 446	0.066
25	16	161 050 447	0.170
32	16	161 050 448	0.144
40	16	161 050 449	0.238
50	16	161 050 450	0.260
63	16	161 050 451	0.398

d (mm)	L3 max (mm)	Diameter of bore in tank side (mm)	D1 (mm)	S (mm)	D (mm)	L2 (mm)	S1 (mm)	L4 (mm)	L1 (mm)	d2 (mm)	G (inch)
16	28	28	29	32	44	11	40	14	58	5	¾
20	28	35	35	40	54	12	50	16	61	5	1
25	28	43	42	50	60	13	55	19	65	5	1 ¼
32	28	49	49	56	69	13	65	22	67	5	1 ½
40	29	61	59	69	84	13	80	26	72	5	2
50	30	67	70	76	92	15	85	31	76	5	2 ¼
63	35	83	82	95	108	15	100	38	84	5	2 ¾



Tank adaptor type 050 PVC-U
Union with spigot/reducing socket metric

Model:

- Gaskets: flat gaskets EPDM
- Washer: PP
- Run-out holes: two holes in octagonal head
- FPM flat gaskets available for tank adaptor type 050



d (mm)	d1 (mm)	PN (bar)	EPDM Code	Weight (kg)
16	12	16	161 050 345	0.068
20	16	16	161 050 346	0.102
25	20	16	161 050 347	0.157
32	25	16	161 050 348	0.220
40	32	16	161 050 349	0.353
50	40	16	161 050 350	0.438
63	50	16	161 050 351	0.680

d (mm)	L (mm)	D (mm)	L1 (mm)	L5 (mm)	L4 (mm)	S1 (mm)	L2 (mm)	S (mm)	D1 (mm)	Diameter of bore in tank side (mm)	L3 max (mm)	G (inch)	d2 (mm)
16	96	44	58	12	14	40	11	32	29	28	19	¾	5
20	104	54	61	14	16	50	12	40	35	35	17	1	5
25	112	60	65	16	19	55	13	50	42	43	18	1 ¼	5
32	119	69	67	19	22	65	13	56	49	49	19	1 ½	5
40	132	84	72	22	26	80	13	69	59	61	16	2	5
50	145	92	76	26	31	85	15	76	70	67	16	2 ¼	5
63	163	108	84	31	38	100	15	95	82	83	19	2 ¾	5



Tank adaptor type 050 PVC-U
Union with solvent cement socket and O-Ring gasket metric

Model:

- Gaskets: O-ring EPDM, flat gasket EPDM
- Washer: PP
- Run-out holes: two holes in octagonal head
- For round tanks

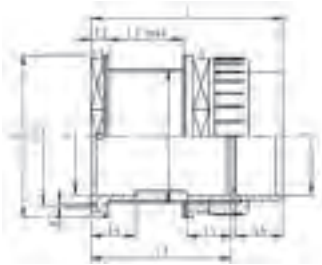

d (mm)	PN (bar)	Code	Weight (kg)
16	16	161 050 385	0.040
20	16	161 050 386	0.070
25	16	161 050 387	0.160
32	16	161 050 388	0.200
40	16	161 050 389	0.240
50	16	161 050 390	0.400
63	16	161 050 391	0.530

d (mm)	G (inch)	d2 (mm)	D1 (mm)	S (mm)	L3 max (mm)	Diameter of bore in tank side (mm)	S1 (mm)	L4 (mm)	L (mm)	L2 (mm)	L1 (mm)	D (mm)
16	¾	5	29	32	19	28	40	14	77	11	58	44
20	1	5	35	40	17	35	50	16	83	12	61	54
25	1 ¼	5	42	50	18	43	55	19	90	13	65	60
32	1 ½	5	49	56	19	49	65	22	95	13	67	69
40	2	5	59	69	16	61	80	26	104	13	72	84
50	2 ¼	5	70	76	16	67	85	31	113	15	76	92
63	2 ¾	5	82	95	19	83	100	38	128	15	84	108



Tank adaptor type 050 PVC-U
Union with solvent cement socket metric

Model:

- Gaskets: flat gaskets EPDM
- Washer: PP
- Run-out holes: two holes in octagonal head
- FPM flat gaskets available for tank adaptor type 050

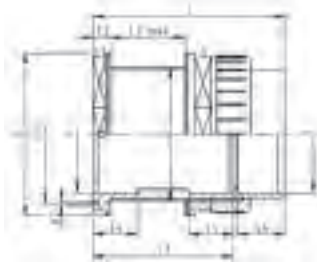

d (mm)	PN (bar)	Code	Weight (kg)
16	16	161 050 245	0.064
20	16	161 050 246	0.070
25	16	161 050 247	0.100
32	16	161 050 248	0.196
40	16	161 050 249	0.328
50	16	161 050 250	0.395
63	16	161 050 251	0.530

d (mm)	L (mm)	L2 (mm)	L1 (mm)	D (mm)	L3 max (mm)	Diameter of bore in tank side (mm)	S1 (mm)	L4 (mm)	d2 (mm)	D1 (mm)	S (mm)	G (inch)
16	77	11	58	44	19	28	40	14	5	29	32	¾
20	83	12	61	54	17	35	50	16	5	35	40	1
25	90	13	65	60	18	43	55	19	5	42	50	1 ¼
32	95	13	67	69	19	49	65	22	5	49	56	1 ½
40	104	13	72	84	16	61	80	26	5	59	69	2
50	113	15	76	92	16	67	85	31	5	70	76	2 ¼
63	128	15	84	108	19	83	100	38	5	82	95	2 ¾



Tank adaptor adjustable PVC-U
Union with spigot/reducing socket metric

Model:

- Gasket: flat gasket EPDM
- Washer: PP
- Spare parts on request



d (mm)	d1 (mm)	Code	Weight (kg)	L3 max (mm)	Diameter of bore in tank side (mm)	G (inch)	L1 (mm)	L2 (mm)	L (mm)	L4 (mm)	s (mm)	M
20	25	161 050 206	0.046	23	28	¾	13	19	42	16	32	
25	32	161 050 207	0.066	23	35	1	15	22	45	19	40	
32	40	161 050 208	0.106	24	43	1 ¼	17	26	49	22	50	
40	50	161 050 209	0.190	21	55	1 ¾	19	31	48	26	60	
50	63	161 050 210	0.248	21	61	2	21	38	52	31	69	
63	75	161 050 211	0.352	23	77	2 ½	23	44	53	38	85	
75	90	161 050 212	0.539	20	89	3	26	51	56	44	100	
90	110	161 050 213	1.083	20	115		32	61	62	51	125	M113
110	125	161 050 214	1.350	22	135		36	69	66	61	147	M133



Backing nut PVC-U tank adaptor

Model:

- With G thread ISO 228/1
- Spare part for tank adaptor type 050

M	G	Code	Weight	D	L	s
(inch)	(inch)		(kg)	(mm)	(mm)	(mm)
	¾	161 490 630	0.007	39	13	32
	1	161 490 632	0.012	48	15	40
	1 ¼	161 490 634	0.019	58	17	50
	1 ½	161 490 635	0.027	65	18	56
	1 ¾	161 490 636	0.036	72	19	64
	2	161 490 637	0.043	79	21	69
	2 ¼	161 490 638	0.053	86	21	76
	2 ½	161 490 639	0.063	94	23	85
	2 ¾	161 490 640	0.092	106	25	95
	3	161 490 641	0.101	112	26	100
M113		161 490 642	0.100	139	32	126
M133		161 490 643	0.100	162	36	147
	4	161 490 644	0.164	139	32	126



Union end PVC-U metric

Model:

- Solvent cement socket metric
- Suitable for unions, tank connectors and diaphragm valves Type 514
- * for unions 721 510 103-114, 721 510 128-139

d	PN	Code	Weight	z	D	D1	L
(mm)	(bar)		(kg)	(mm)	(mm)	(mm)	(mm)
10	16	721 500 103	0.004	3	20	18	15
12	16	721 500 104	0.003	3	20	18	15
16	16	721 500 105	0.003	3	24	22	17
20	16	721 500 106	0.008	3	30	28	19
25	16	721 500 107	0.014	3	39	36	22
32	16	721 500 108	0.020	3	45	42	25
40	16	721 500 109	0.037	3	57	53	29
50	16	721 500 110	0.039	3	63	59	34
63	16	721 500 111	0.072	3	78	74	41
75	10	721 500 162	0.140	3	101	90	47
90	10	721 500 163	0.242	5	121	108	56
110	10	721 500 164	0.390	5	146	131	66
*	75	721 600 112	0.155	3	97	90	47
*	90	721 600 113	0.188	5	110	105	56



Union end with spigot PVC-U metric

Model:

- Solvent cement spigot in combination with reducing socket metric
- Suitable for unions, tank connectors and diaphragm valves Type 514

	d (mm)	d1 (mm)	PN (bar)	Code	Weight (kg)	z (mm)	z1 (mm)	D (mm)	D1 (mm)	L (mm)
*	16	12	16	721 500 405	0.010	22	24	24	22	36
*	20	16	16	721 500 406	0.009	24	26	30	28	40
*	25	20	16	721 500 407	0.026	25	28	39	36	44
*	32	25	16	721 500 408	0.035	27	30	45	42	49
	40	32	16	721 500 409	0.055	31	35	57	53	57
	50	40	16	721 500 410	0.085	35	40	63	59	66
	63	50	16	721 500 411	0.108	39	46	79	74	77



Union end PVC-U metric

Model:

- For tap connector code no. 721 550 305-307

	d (mm)	d1 (mm)	PN (bar)	Code	Weight (kg)	z (mm)	D (mm)	L (mm)	L1 (mm)
	16	12	16	721 600 305	0.005	22	19	34	3
	20	16	16	721 600 306	0.009	24	24	38	5
	25	20	16	721 600 307	0.016	27	30	43	5



Union end PVC-U Rp

Model:

- Parallel female thread Rp

Rp (inch)	PN (bar)	Code	Weight (kg)	z (mm)	D (mm)	D1 (mm)	L (mm)
¼	10	721 600 654	0.004	5	20	18	15
⅜	10	721 600 655	0.005	6	24	22	17
½	10	721 600 656	0.010	6	30	28	19
¾	10	721 600 657	0.015	7	39	36	22
1	10	721 600 658	0.019	8	45	42	25
1 ¼	10	721 600 659	0.038	10	57	53	29
1 ½	10	721 600 660	0.057	11	63	59	34
2	10	721 600 661	0.102	18	78	74	41



Union end blank PVC-U

Model:

- For unions, tank adaptor and diaphragm valve type 514
- Flat sealing faces

d (mm)	DN (mm)	Inch (inch)	PN (bar)	Code	Weight (kg)	D (mm)	D1 (mm)	L (mm)	L1 (mm)
10/12		1/8	16	721 600 004	0.006	20	18	9	4
16	10	3/8	16	721 600 005	0.004	24	22	10	5
20	15	1/2	16	721 600 006	0.009	30	28	11	5
25	20	3/4	16	721 600 007	0.017	39	36	11	6
32	25	1	16	721 600 008	0.025	45	42	12	6
40	32	1 1/4	16	721 600 009	0.042	57	53	13	7
50	40	1 1/2	16	721 600 010	0.061	63	59	16	7
63	50	2	16	721 600 011	0.108	78	74	18	8
75	65	2 1/2	10	721 600 012	0.216	101	90	22	10
90	80	3	10	721 600 013	0.333	121	108	24	11
110	100	4	10	721 600 014	0.530	146	131	26	12



Union nut PVC-U

* for Adaptor unions PVC-U / malleable iron only

d (mm)	PN (bar)	Code	Weight (kg)	Tr	G (inch)	D (mm)	L (mm)
10 - 12	16	721 890 004	0.009		5/8	19	19
16	16	721 890 005	0.011		3/4	22	21
20	16	721 890 006	0.020		1	28	23
25	16	721 890 007	0.020		1 1/4	36	24
32	16	721 890 008	0.030		1 1/2	41	26
40	16	721 890 009	0.049		2	53	29
50	16	721 890 010	0.087		2 1/4	59	34
63	16	721 890 011	0.138		2 3/4	74	38
75	10	721 890 012	0.256	Tr 108x5		92	40
90	10	721 890 013	0.370	Tr 128x5		110	43
*	90	721 890 023	0.355	Tr 128x5		105	43
	110	721 890 014	0.574	Tr 154x6		133	48

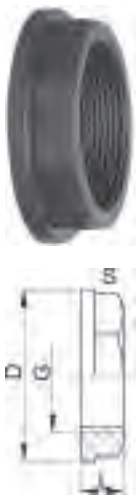

Backing nut PVC-U tank adaptor

Model:

- With G thread ISO 228/1
- Spare part for tank adaptor type 050

M (inch)	G	Code	Weight (kg)	D (mm)	L (mm)	s (mm)
3/4	161 490 630	0.007	39	13	32	
1	161 490 632	0.012	48	15	40	
1 1/4	161 490 634	0.019	58	17	50	
1 1/2	161 490 635	0.027	65	18	56	
1 3/4	161 490 636	0.036	72	19	64	
2	161 490 637	0.043	79	21	69	
2 1/4	161 490 638	0.053	86	21	76	
2 1/2	161 490 639	0.063	94	23	85	
2 3/4	161 490 640	0.092	106	25	95	

table continued on the next page

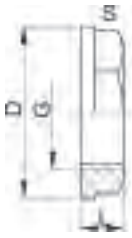

M	G	Code	Weight	D	L	s
	(inch)		(kg)	(mm)	(mm)	(mm)
	3	161 490 641	0.101	112	26	100
M113		161 490 642	0.100	139	32	126
M133		161 490 643	0.100	162	36	147
	4	161 490 644	0.164	139	32	126



ecoFIT union end

Model:

- Material: PE80
- With fusion socket metric
- Suitable for unions, tank connectors and diaphragm valves Type 514

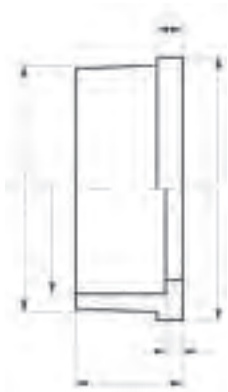

d	PN	Code	Weight	d1	d2	L	L1	z
(mm)	(bar)		(kg)	(mm)	(mm)	(mm)	(mm)	(mm)
20	10	734 600 106	0.006	28	30	19	5	5
25	10	734 600 107	0.013	36	39	21	5	5
32	10	734 600 108	0.015	42	45	23	6	5
40	10	734 600 109	0.026	53	57	25	6	5
50	10	734 600 110	0.027	59	63	28	7	5
63	10	734 600 111	0.044	74	79	32	8	5



ecoFIT union end S5/SDR11

Model:

- Material: PE100
- IR = Infrared- (IR Plus) compatible.
- **For the dimensions d75-110 please see instructions for the installation**
- Conventional butt-welding according to DVS 2207



d	PN	FM	Code	Weight	D	L	L1	e
(mm)	(bar)			(kg)	(mm)	(mm)	(mm)	(mm)
20	16	IR	753 508 606	0.011	30	54	38	1.9
25	16	IR	753 508 607	0.018	39	57	42	2.3
32	16	IR	753 508 608	0.027	45	60	41	2.9
40	16	IR	753 508 609	0.044	57	63	42	3.7
50	16	IR	753 508 610	0.061	63	66	44	4.6
63	16	IR	753 508 611	0.100	78	69	45	5.8
75	10	IR	753 608 612	0.147	101	66	34	6.8
90	10	IR	753 608 613	0.156	101	66	55	8.2
110	10	IR	753 608 614	0.226	121	66	55	10.0



ecoFIT Union end long SDR11

Model:

- Material: PE100
- Suitable for unions, tank connectors and diaphragm valves Type 514
- For butt-, IR Plus® and electrofusion



d	PN	FM	Code	Weight	D	L	L1	e
(mm)	(bar)			(kg)	(mm)	(mm)	(mm)	(mm)
20	16	IR	753 508 616	0.006	30	67	52	1.9
25	16	IR	753 508 617	0.019	39	71	53	2.3
32	16	IR	753 508 618	0.027	45	73	55	2.9
40	16	IR	753 508 619	0.048	57	81	60	3.7
50	16	IR	753 508 620	0.069	63	87	66	4.6
63	16	IR	753 508 621	0.120	78	93	70	5.8



ecoFIT union end SDR17.6

Model:

- Material: PE100
- IR = Infrared- (IR Plus) compatible.
- **For the dimensions d75-110 please see instructions for the installation**
- Conventional butt-welding according to DVS 2207



d	PN	FM	Code	Weight	D	L	L1	e
(mm)	(bar)			(kg)	(mm)	(mm)	(mm)	(mm)
75	10	IR	753 608 412	0.124	101	66	34	4.3
90	10	IR	753 608 413	0.131	101	66	57	5.1
110	10	IR	753 608 414	0.178	121	66	55	6.3



Union end stainless steel Rp

Model:

- Material: stainless steel 1.4404 (316L)
- Parallel female thread Rp



Rp	PN	Code	Weight	z	D	D1	L	s
(inch)	(bar)		(kg)	(mm)	(mm)	(mm)	(mm)	(mm)
3/8	16	724 600 655	0.030	9	24	22	19	19
1/2	16	724 600 656	0.060	11	30	28	24	24
3/4	16	724 600 657	0.092	11	39	36	26	29
1	16	724 600 658	0.137	12	45	42	29	36
1 1/4	16	724 600 659	0.226	14	57	53	33	45
1 1/2	16	724 600 660	0.314	15	63	59	34	54
2	16	724 600 661	0.438	15	78	74	39	63



Union end stainless steel R

Model:

- Material: stainless steel 1.4404 (316L)
- Taper male thread R



R	PN	Code	Weight	D	D1	L	s
(inch)	(bar)		(kg)	(mm)	(mm)	(mm)	(mm)
3/8	16	724 600 705	0.052	24	22	30	19
1/2	16	724 600 706	0.083	30	28	34	24
3/4	16	724 600 707	0.125	39	36	36	32

table continued on the next page



R (inch)	PN (bar)	Code	Weight (kg)	D (mm)	D1 (mm)	L (mm)	s (mm)
1	16	724 600 708	0.189	45	42	40	37
1 ¼	16	724 600 709	0.356	57	53	46	48
1 ½	16	724 600 710	0.407	63	59	48	54
2	16	724 600 711	0.668	78	74	55	69



**Union end stainless steel
Welding end**

Model:

- Material: stainless steel 1.4404 (316L)



d1 (mm)	d (mm)	PN (bar)	Code	Weight (kg)	D (mm)	D1 (mm)	L (mm)	e (mm)
17	16	16	724 605 505	0.029	24	22	18	1.6
21	20	16	724 605 506	0.046	30	28	22	2.0
26	25	16	724 605 507	0.080	39	36	23	2.0
33	32	16	724 605 508	0.112	45	42	26	2.0
42	40	16	724 605 509	0.188	57	53	26	2.0
48	50	16	724 605 510	0.222	63	59	28	2.0
60	63	16	724 605 511	0.361	78	74	32	2.6



Union nut stainless steel 1.4404 (316L)

- * Octagon union nut



d (mm)	PN (bar)	Code	Weight (kg)	G (inch)	closest inch (inch)	L (mm)	s (mm)	
16	16	724 690 105	0.060	¾	¾	19	32	
20	16	724 690 106	0.105	1	½	21	41	
25	16	724 690 107	0.091	1 ¼	¾	23	46	
32	16	724 690 108	0.170	1 ½	1	24	55	
*	40	16	724 690 109	0.218	2	1 ¼	27	68
*	50	16	724 690 110	0.316	2 ¼	1 ½	31	74
*	63	16	724 690 111	0.364	2 ¾	2	35	88



Union bush PVC-U metric

Model:

- Solvent cement socket metric
- Jointing face: with O-ring groove
- Gasket: O-ring EPDM code no. 748 410 004-016; d90 748 410 248



d (mm)	PN (bar)	Code	Weight (kg)	z (mm)	D (mm)	L (mm)	G/Tr (inch)
10	16	721 840 103	0.002	10	20	22	5/8
12	16	721 840 104	0.007	10	20	22	5/8
16	16	721 840 105	0.009	10	24	24	3/4
20	16	721 840 106	0.014	10	29	26	1
25	16	721 840 107	0.020	10	34	29	1 1/4
32	16	721 840 108	0.032	10	42	33	1 1/2
40	16	721 840 109	0.057	12	52	39	2
50	16	721 840 110	0.073	14	62	46	2 1/4

table continued on the next page



d (mm)	PN (bar)	Code	Weight (kg)	z (mm)	D (mm)	L (mm)	G/Tr (inch)
63	16	721 840 111	0.137	18	78	58	2 3/4
75	10	721 840 112	0.210	18	93	62	Tr108x5
90	10	721 840 123	0.355	18	110	69	Tr128x5
110	10	721 840 114	0.445	11	133	72	Tr154x6

Union bush PVC-U Rp

Model:

- With parallel female thread Rp
- Jointing face: with O-ring groove
- Gasket: O-ring EPDM code no. 748 410 004-011
- Connection to plastic thread only
- Do not use thread sealing pastes that are harmful to PVC-U



Rp (inch)	PN (bar)	Code	Weight (kg)	G (inch)	z (mm)	D (mm)	L (mm)
1/4	10	721 840 604	0.007	5/8	12	20	22
3/8	10	721 840 605	0.009	3/4	13	24	24
1/2	10	721 840 606	0.013	1	13	29	26
3/4	10	721 840 607	0.026	1 1/4	14	34	29
1	10	721 840 608	0.036	1 1/2	15	42	32
1 1/4	10	721 840 609	0.063	2	19	53	38
1 1/2	10	721 840 610	0.098	2 1/4	26	63	45
2	10	721 840 611	0.187	2 3/4	33	78	56

Union end brass Rp

Model:

- Union End: Brass with parallel female thread Rp



Rp (inch)	d (mm)	Code	Weight (kg)	L (mm)	s (mm)	D (mm)	D1 (mm)	z (mm)
1/2	20	720 600 236	0.059	22	25	30	28	5
3/4	25	720 600 237	0.100	25	30	39	36	6
1	32	720 600 238	0.128	27	36	45	42	6
1 1/4	40	720 600 239	0.211	31	46	56	53	7
1 1/2	50	720 600 240	0.324	35	55	62	59	7
2	63	720 600 241	0.510	40	65	78	74	8
2 1/2	75	720 600 242	0.893	47	85	100	92	10
3	90	720 600 243	1.395	52	95	121	110	11

Union end brass R

Model:

- Union End: Brass with taper male thread R

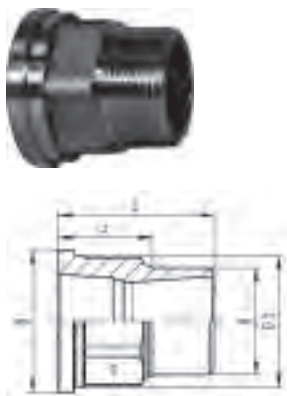

d (mm)	R (inch)	Code	Weight (kg)	z (mm)	D1 (mm)	D (mm)	s (mm)	L (mm)
20	1/2	720 600 246	0.092	22	28	30	25	37
25	3/4	720 600 247	0.151	25	36	39	30	42
25	1/2	720 600 257	0.142	27	36	39	30	42
32	1	720 600 248	0.216	28	42	45	36	46
32	1/2	720 600 258	0.113	31	42	45	36	46
32	3/4	720 600 268	0.206	30	42	45	36	46

table continued on the next page



d (mm)	R (inch)	Code	Weight (kg)	z (mm)	D1 (mm)	D (mm)	s (mm)	L (mm)
40	1 ¼	720 600 249	0.408	32	53	56	46	52
50	1 ½	720 600 250	0.538	36	59	62	55	56
63	2	720 600 251	0.859	42	74	78	65	67
75	2 ½	720 600 252	1.446	49	92	100	85	77
90	3	720 600 253	2.063	54	110	121	95	86

Union nut, brass

- d12 - d20 for tap connector No. 21 55 03



PN (bar)	d (mm)	G (inch)	Code	Weight (kg)	L (mm)	s (mm)
16	16	½	720 690 405	0.024	16	24
16	16	¾	720 690 005	0.040	17	30
16	20	1	720 690 006	0.065	19	38
16	25	1 ¼	720 690 007	0.105	20	47
16	32	1 ½	720 690 008	0.102	22	52
16	40	2	720 690 009	0.199	25	66
16	50	2 ¼	720 690 010	0.268	25	72
16	63	2 ¾	720 690 011	0.280	27	87
16	75	3 ½	720 690 012	0.675	34	110

Union end malleable iron galvanized Rp

Model:

- Union End: malleable iron with parallel female thread Rp

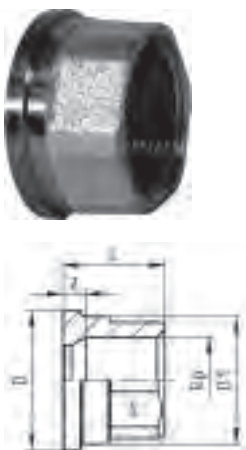

d (mm)	Rp (inch)	PN (bar)	Code	Weight (kg)	D (mm)	L (mm)	s (mm)	z (mm)	D1 (mm)
20	¾	16	724 600 206	0.037	30	22	25	9	27
25	1	16	724 600 207	0.072	39	22	31	7	36
32	1 ¼	16	724 600 208	0.088	44	26	38	9	41
40	1 ½	16	724 600 209	0.172	56	31	48	12	52
50	2	16	724 600 210	0.210	62	33	54	14	58
63	2 ¼	16	724 600 211	0.324	78	35	67	11	73
75	2 ½	16	724 600 212	0.557	100	39	85	12	92
90	3	16	724 600 213	0.650	121	45	96	15	110

Union end malleable iron galvanized R

Model:

- Union End: Malleable iron with taper male thread R



R (inch)	d (mm)	Code	Weight (kg)	D (mm)	L (mm)	D1 (mm)	z (mm)	s (mm)
½	20	724 600 806	0.069	30	40	27	25	23
¾	25	724 600 807	0.115	39	43	36	27	30
1	32	724 600 808	0.161	44	48	41	29	36
1 ¼	40	724 600 809	0.294	56	57	52	36	48
1 ½	50	724 600 810	0.353	62	59	58	37	54
2	63	724 600 811	0.570	78	62	73	36	66
2 ½	75	724 600 812	0.980	100	75	92	45	85
3	90	724 600 813	1.217	121	80	110	47	95



Union bush malleable iron galvanized Rp

Model:

- Parallel female thread Rp

PN (bar)	Rp (inch)	d (mm)	Code	Weight (kg)	G (inch)	z (mm)	s (mm)	L (mm)
16	½	20	724 630 606	0.058	1	12	25	25
16	¾	25	724 630 607	0.100	1 ¼	13	31	28
16	1	32	724 630 608	0.127	1 ½	14	28	31
16	1 ¼	40	724 630 609	0.204	2	14	47	33
16	1 ½	50	724 630 610	0.268	2 ¼	17	53	36
16	2	63	724 630 611	0.443	2 ¾	18	66	42
16	2 ½	75	724 630 612	0.679	3 ½	19	82	46
16	3	90	724 630 613	0.913	4	22	96	52

Seals

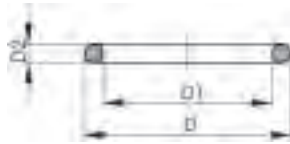

O-Ring gasket

Model:

- For unions and adaptor unions
- Hardness approx. 65° Shore
- EPDM minimum temperature -40°C
- FPM minimum temperature -15°C
- * for unions PVC-U, PVC-C and ABS: 21 51 01, 21 51 11, 21 53 03, 21 53 08, 21 55 04, 21 55 13, 21 55 18, 23 51 01 and 29 51 01 only

d (mm)	DN (mm)	EPDM Code	Weight (kg)	FPM Code	Weight (kg)	D (mm)	D1 (mm)	D2 (mm)	closest inch (inch)
10 - 12	8	748 410 004	0.002	749 410 004	0.020	18	12	3	¼
16	10	748 410 005	0.004	749 410 005	0.002	21	16	3	⅜
20	15	748 410 006	0.002	749 410 006	0.002	27	20	4	½
25	20	748 410 007	0.002	749 410 007	0.002	35	28	4	¾
32	25	748 410 008	0.003	749 410 008	0.002	40	33	4	1
40	32	748 410 009	0.003	749 410 009	0.007	51	41	5	1 ¼
50	40	748 410 010	0.004	749 410 010	0.060	58	47	5	1 ½
63	50	748 410 011	0.005	749 410 011	0.003	70	60	5	2
75	65	748 410 014	0.007	749 410 014	0.012	93	82	5	2 ½
90	80	748 410 015	0.008	749 410 015	0.015	112	101	5	3
*	90	748 410 248	0.008	749 410 248	0.020	105	95	5	3
110	100	748 410 016	0.016	749 410 016	0.031	134	120	7	4



Flat gasket

Model:

- Hardness approx. 65° Shore
- For adaptor unions

Size (inch)	EPDM Code	Weight (kg)	FPM Code	Weight (kg)	D (mm)	D1 (mm)	H (mm)
¼	748 400 004	0.002			20	13	2
⅜	748 400 005	0.002	749 400 005	0.020	24	17	2
½	748 400 006	0.002	749 400 006	0.003	30	21	3
¾	748 400 007	0.004	749 400 007	0.004	38	27	3
1	748 400 008	0.002	749 400 008	0.002	44	32	3
1 ¼	748 400 009	0.007	749 400 009	0.003	55	42	3
1 ½	748 400 010	0.004	749 400 010	0.007	62	46	3
2	748 400 011	0.005	749 400 011	0.006	78	60	3
2 ½	748 400 012	0.010	749 400 012	0.009	97	75	3
3	748 400 013	0.011	749 400 013	0.011	109	88	3

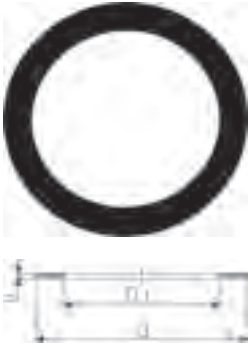

Flat gasket

Model:

- Hardness approx. 65° Shore
- For tap connectors No. 21 55 03

Attention:

- For tap connector d16 - 1/2": 748 400 030
- For tap connector d20 - 3/4": 748 400 005
- For tap connector d25 - 1": 748 400 006

d (mm)	EPDM Code	Weight (kg)	D (mm)	D1 (mm)	H (mm)
16	748 400 030	0.020	18	14	2
20	748 400 005	0.002	24	17	2
25	748 400 006	0.002	30	21	3



Flat Gasket inside the tank For tank adaptor type 050

Model:

- Hardness approx. 65° Shore
- Dimension size "inch" correspond with the thread dimension "G" of the tank adaptor

Size (inch)	EPDM Code	Weight (kg)	FPM Code	Weight (kg)	D (mm)	D1 (mm)	H (mm)
¾	748 400 007	0.004	749 400 007	0.004	38	27	3
1	748 400 042	0.003	749 400 042	0.003	46	34	3
1 ¼	748 400 009	0.007	749 400 009	0.003	55	42	3
1 ½	748 400 043	0.005	749 400 043	0.009	62	48	3
2	748 400 011	0.005	749 400 011	0.006	78	60	3
2 ¼	748 400 044	0.008	749 400 044	0.009	85	75	3
2 ¾	748 400 045	0.011	749 400 045	0.011	106	82	3



Flat Gasket union For tank adaptor type 050

Model:

- Hardness approx. 65° Shore
- Dimension size "inch" correspond with the thread dimension "G" of the tank adaptor

Size (inch)	EPDM Code	Weight (kg)	FPM Code	Weight (kg)	D (mm)	D1 (mm)	H (mm)
¾	748 400 005	0.002	749 400 005	0.020	24	17	2
1	748 400 006	0.002	749 400 006	0.003	30	21	3
1 ¼	748 400 007	0.004	749 400 007	0.004	38	27	3
1 ½	748 400 008	0.002	749 400 008	0.002	44	32	3
2	748 400 009	0.007	749 400 009	0.003	55	42	3
2 ¼	748 400 010	0.004	749 400 010	0.007	62	46	3
2 ¾	748 400 011	0.005	749 400 011	0.006	78	60	3



Washer PP for tank adaptor

Model:

- Spare part for tank adaptor type 050

d (mm)	Code	Weight (kg)	H (mm)	D1 (mm)	D (mm)
3/4	727 490 005	0.002	3	27	39
1	727 490 006	0.002	3	34	47
1 1/4	727 490 007	0.010	3	43	58
1 1/2	727 490 108	0.004	4	49	65
1 3/4	727 490 008	0.024	4	55	72
2	727 490 009	0.028	4	61	79
2 1/4	727 490 010	0.007	4	67	86
2 1/2	727 490 011	0.008	4	77	95
2 3/4	727 490 111	0.013	4	83	106
3	727 490 012	0.013	5	90	112
M113	727 490 013	0.021	5	115	139
M133	727 490 014	0.025	5	135	160

Flange adaptors and flanges



Flange adaptor PVC-U Combined jointing face flat and serrated metric

Model:

- Solvent cement socket metric
- d63 - d400: combined jointing face flat and serrated
- Gasket: profile flange gasket EPDM code no. 748 440 705-725, FPM code no. 749 440 705-725 or flat gasket EPDM code no. 748 440 705-725, only use O-ring EPDM code no. 748 410 000-174, FPM code no. 749 410 000-174 in combination with counterpart flange adaptor code no. 721 810 105-123
- Flange: PVC-U code no. 721 700 005-140, PP with steel ring code no. 727 700 206-225, backing flange PP-V for socket systems metric code no. 727 700 406-425

Note:

* bevel on pipe may be needed if used with butterfly valve type 037/038/039

The flat gasket affects the maximum allowable operating pressure!

DN (mm)	d (inch)	d (mm)	PN (bar)	Code	Weight (kg)	D1 (mm)	z (mm)	L (mm)	D (mm)	L1 (mm)
10		16	16	721 800 105	0.006	29	3	17	22	6
15		20	16	721 800 106	0.009	34	3	19	27	6
20		25	16	721 800 107	0.015	41	3	22	33	7
25		32	16	721 800 108	0.024	50	3	25	41	7
32		40	16	721 800 109	0.039	61	3	29	50	8
40		50	16	721 800 110	0.056	73	3	34	61	8
50		63	16	721 790 111	0.103	90	3	41	77	9
65	2 ½	75	16	721 790 112	0.159	106	3	47	91	10
80		90	16	721 790 113	0.253	125	5	56	108	11
100		110	16	721 790 114	0.417	150	5	66	131	12
100		125	16	721 790 115	0.533	170	5	74	148	13
125	5	140	16	721 790 116	0.725	188	5	81	165	14
150		160	16	721 790 117	1.093	213	5	91	188	16
*	200	200	10	721 790 119	1.460	250	6	112	224	24
	200	225	10	721 790 120	1.743	274	6	125	248	25
*	250	250	10	721 790 121	2.203	303	9	140	274	23
	250	280	10	721 790 122	2.930	329	5	151	308	23
*	300	315	6	721 790 123	4.455	379	8	172	346	27
	350	355	6	721 790 124	5.963	430	10	194	384	32
	400	400	6	721 790 125	9.041	482	10	216	438	34



Flange adaptor PVC-U Joining face with O-ring groove metric

Model:

- Solvent cement socket metric
- Counterpart: flange adaptor flat code no. 721 800 105-721 790 111-125, combined flange adaptor (d160, d200, d225, d280, d315)
- Gasket: O-ring EPDM code no. 748 410 000-176, FPM code no. 749 410 000-176
- Flange: PVC-U code no. 721 700 005-138, PP/steel code no. 727 700 206-223, PP-V for socket systems metric code no. 727 700 406-423



d	d	DN	PN	Code	Weight	D1	z	D	L	L1
(inch)	(mm)	(mm)	(bar)		(kg)	(mm)	(mm)	(mm)	(mm)	(mm)
	16	10	16	721 810 105	0.008	29	6	22	20	9
	20	15	16	721 810 106	0.011	34	6	27	22	9
	25	20	16	721 810 107	0.018	41	6	33	25	10
	32	25	16	721 810 108	0.027	50	6	41	28	10
	40	32	16	721 810 109	0.046	61	8	50	34	13
	50	40	16	721 810 110	0.068	73	8	61	39	13
	63	50	16	721 810 111	0.120	90	8	77	46	14
2 ½	75	65	16	721 810 112	0.183	106	8	91	52	15
	90	80	16	721 810 113	0.286	125	10	108	61	16
	110	100	16	721 810 114	0.478	150	11	131	72	18
	125	100	16	721 810 115	0.607	170	11	148	80	19
5	140	125	16	721 810 116	0.804	188	11	165	87	20
	160	150	16	721 810 117	1.226	213	11	188	97	22
	200	200	10	721 810 119	1.593	250	12	224	118	30
	225	200	10	721 810 120	1.878	274	12	248	131	31
	250	250	10	721 810 121	2.175	303	9	274	140	23
	280	250	10	721 810 122	3.170	329	13	308	158	30
	315	300	6	721 810 123	4.891	379	17	346	180	35



Backing flange PVC-U metric

Model:

- For socket systems metric and BS
- Connecting dimension: ISO 7005, EN 1092, BS 4504, DIN 2501
- **Bolt circle PN 10**
- Maximum medium- or ambient temperature 45 °C

¹⁾ Connecting dimension: ISO 2536, bolt circle acc. DN125, suitable for flange adaptor d125/ DN100

²⁾ Connecting dimension: ISO 2536, bolt circle acc. DN225, suitable for flange adaptor d250/ DN250

³⁾ Not for BS

AL: number of holes

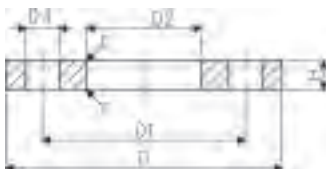

d	Size	DN	PN	Code	Weight
(mm)	(inch)	(mm)	(bar)		(kg)
16	¾	10	10	721 700 005	0.053
20	½	15	10	721 700 006	0.067
25	¾	20	10	721 700 007	0.092
32	1	25	10	721 700 008	0.133
40	1 ¼	32	10	721 700 009	0.198
50	1 ½	40	10	721 700 010	0.247
63	2	50	10	721 700 011	0.312
75	2 ½	65	10	721 700 012	0.376
90	3	80	10	721 700 013	0.464
3	110	4	100	721 700 014	0.543
1	125	4 ½	125	721 700 015	0.904
	140	5	125	721 700 016	0.758
	160	6	150	721 700 017	1.009
	200	7	200	721 700 019	1.669
	225	8	200	721 700 020	1.377
	250	9	250	721 700 021	2.376

table continued on the next page

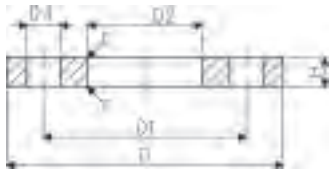

	d	Size	DN	PN	Code	Weight
	(mm)	(inch)	(mm)	(bar)		(kg)
2	250	9	225	6	721 700 136	1.800
	280	10	250	6	721 700 137	1.746
	315	12	300	6	721 700 138	2.349
	355	14	350	6	721 700 139	3.485
	400	16	400	6	721 700 140	4.526

	d	D	D1	D2	D3	H	r	AL	SC
	(mm)	(mm)	(mm)	(mm)	(mm)	(mm)	(mm)		
	16	90	60	23	14	10	1	4	M12
	20	95	65	28	14	11	1	4	M12
	25	105	75	34	14	12	2	4	M12
	32	115	85	42	14	14	2	4	M12
	40	140	100	51	18	15	2	4	M16
	50	150	110	62	18	16	2	4	M16
	63	165	125	78	18	18	3	4	M16
	75	185	145	92	18	19	3	4	M16
	90	200	160	110	18	20	3	8	M16
3	110	220	180	133	18	22	3	8	M16
1	125	250	210	150	18	26	5	8	M16
	140	250	210	167	18	26	4	8	M16
	160	285	240	190	22	28	4	8	M20
	200	340	295	226	22	32	4	8	M20
	225	340	295	250	22	32	4	8	M20
	250	395	350	277	22	36	4	12	M20
2	250	370	325	277	22	36	4	8	M20
	280	395	350	310	22	36	4	12	M20
	315	445	400	348	22	36	4	12	M20
	355	505	460	388	22	38	5	16	M20
	400	565	515	442	26	42	5	16	M24

Backing flange PVC-U Inch ANSI

Model:

- For socket systems metric and BS
- Connecting dimension: ANSI/ASME B 16.5 class 150, ASTM D 4024, BS 1560, BS EN 1759
- **Bolt circle class 150**

* Only for use with metric flange adaptors

AL: number of holes

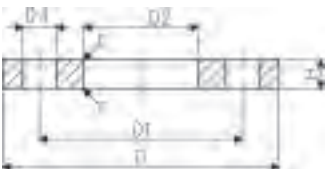

	Size	d	DN	PN	Code	Weight	D	D1	D2	D3	H	r	AL
	(inch)	(mm)	(mm)	(bar)		(kg)	(mm)	(mm)	(mm)	(mm)	(mm)	(mm)	
	½		15	10	721 702 206	0.068	95	60	28	16	11	1	4
	¾		20	10	721 702 207	0.090	105	70	34	16	12	2	4
	1		25	10	721 702 208	0.128	115	79	42	16	14	2	4
	1 ¼		32	10	721 702 209	0.203	140	89	51	16	15	2	4
	1 ½		40	10	721 702 210	0.238	150	98	62	16	16	2	4
	2		50	10	721 702 211	0.302	165	121	78	19	18	3	4
	2 ½		65	10	721 702 212	0.369	185	140	92	19	19	3	4
	3		80	10	721 702 213	0.509	200	152	110	19	20	3	4
	4		100	10	721 702 214	0.516	220	190	138	19	22	3	8
*	4	110	100	10	161 483 180	0.538	220	190	133	19	22	3	8
	5		125	10	721 702 216	0.737	250	216	167	22	26	4	8
	6		150	10	721 702 217	1.910	285	241	200	22	28	4	8
	8		200	10	721 702 220	1.360	340	298	250	22	32	4	8

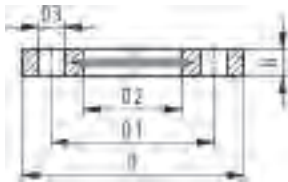

Backing flange PP-V metric For socket systems metric and BS

Model:

- Connecting dimension: ISO 7005, EN 1092, BS 4504, DIN 2501
- **Bolt circle PN 10**
- Full-plastic flange PP-GF (30 % glass-fibre reinforced)
- 1) Suitable for socket- and butt fusion systems
- 2) Not for BS
- * Combined version, metric-ANSI
- AL: number of holes

	d (mm)	DN (mm)	PN (bar)	Code	Weight (kg)	D (mm)	D1 (mm)	D2 (mm)	D3 (mm)	H (mm)	AL	SC
	1	20	15	16	727 700 406	0.093	95	65	28	14	16	4 M12
	1	25	20	16	727 700 407	0.120	105	75	34	14	17	4 M12
	1	32	25	16	727 700 408	0.151	115	85	42	14	18	4 M12
	1	40	32	16	727 700 409	0.244	140	100	51	18	20	4 M16
	1	50	40	16	727 700 410	0.297	150	110	62	18	22	4 M16
	1	63	50	16	727 700 411	0.362	165	125	78	18	24	4 M16
	1	75	65	16	727 700 412	0.487	185	145	92	18	26	4 M16
		90	80	16	727 700 413	0.550	200	160	110	18	27	8 M16
	2	110	100	16	727 700 414	0.640	220	180	133	18	28	8 M16
		140	125	16	727 700 416	0.781	250	210	167	18	30	8 M16
		160	150	16	727 700 417	1.050	285	241	190	22	32	8 M20
	*	200	200	16	727 700 419	1.629	340	297	226	22	34	8 M20
	*	225	200	16	727 700 420	1.400	340	297	250	22	34	8 M20
		250	250	16	727 700 421	2.229	395	350	277	22	38	12 M20
		280	250	16	727 700 422	1.651	395	350	310	22	38	12 M20
		315	300	16	727 700 423	2.461	445	400	348	22	42	12 M20
		355	350	10	727 700 424	3.000	515	460	388	22	46	16 M20
		400	400	10	727 700 425	5.135	574	515	442	26	50	16 M24

Fixed flange PVC-U Jointing face flat metric

Model:

- **Bolt circle PN 10**
- Solvent cement socket metric
- Connecting dimension: ISO 7005 PN 10, EN 1092 PN 10, DIN 2501 PN 10, BS 4504 PN 10
- * Combined Flange, connecting dimensions EN1092 PN 10 and ANSI B 16.5 Class 150

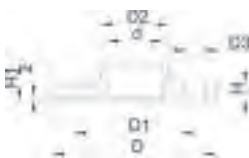

	d (mm)	DN (mm)	Size (inch)	PN (bar)	Code	Weight (kg)
	20	15	½	16	721 730 206	0.098
	25	20	¾	16	721 730 207	0.130
	32	25	1	16	721 730 208	0.183
	40	32	1 ¼	16	721 730 209	0.305
	50	40	1 ½	16	721 730 210	0.365
	63	50	2	16	721 730 211	0.510
	*	75	2 ½	10	721 730 212	0.520
	*	90	3	10	721 730 213	0.720
	*	110	4	10	721 730 214	0.920
	*	140	5	10	721 730 216	1.380
	*	160	6	10	721 730 217	2.039

	d (mm)	D (mm)	D1 (mm)	D2 (mm)	D3 (mm)	z (mm)	H (mm)	H1 (mm)	AL	SC
	20	95	65	27	14	3	12	19	4	M12
	25	105	75	33	14	3	13	22	4	M12
	32	115	85	41	14	3	14	25	4	M12
	40	140	100	51	18	3	17	29	4	M16
	50	150	110	62	18	3	17	34	4	M16

table continued on the next page

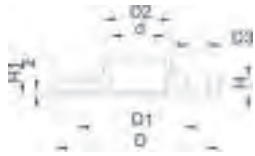

	d (mm)	D (mm)	D1 (mm)	D2 (mm)	D3 (mm)	z (mm)	H (mm)	H1 (mm)	AL	SC
	63	165	125	77	18	3	20	41	4	M16
*	75	185	142	91	22	3	21	47	4	M20
*	90	200	156	108	22	5	22	56	8	M20
*	110	220	186	131	24	5	24	66	8	M20
*	140	250	215	165	23	5	28	91	8	M20
*	160	285	240	188	23	5	30	91	8	M20

Fixed flange PVC-U
Combined jointing face: flat and serrated metric

Model:

- Solvent cement socket metric
- Connecting dimension: ISO 7005 PN 10, EN 1092 PN 10, DIN 2501 PN 10, BS 4504 PN 10
- **Bolt circle PN 10**

* Combined Flange, connecting dimensions EN1092 PN 10 and ANSI B 16.5 Class 150
d75 - d110: bolt hole as long hole version

AL: number of holes



	d (mm)	DN (mm)	d (inch)	PN (bar)	Code	Weight (kg)
	20	15		16	721 740 106	0.100
	25	20		16	721 740 107	0.130
	32	25		16	721 740 108	0.185
	40	32		16	721 740 109	0.306
	50	40		16	721 740 110	0.368
	63	50		16	721 740 111	0.513
*	75	65	2 ½	10	721 740 112	0.536
*	90	80	3	10	721 740 113	0.710
*	110	100	4	10	721 740 114	0.941
*	140	125	5	10	721 740 116	1.395
*	160	150	6	10	721 740 117	2.029

	d (mm)	D (mm)	D1 (mm)	D1 max. (mm)	D1 min. (mm)	D2 (mm)	D3 (mm)	z (mm)	H (mm)	H1 (mm)	AL	SC
	20	95	65			27	14	3	12	19	4	M12
	25	105	75			33	14	3	13	22	4	M12
	32	115	85			41	14	3	14	25	4	M12
	40	140	100			51	18	3	17	29	4	M16
	50	150	110			62	18	3	17	34	4	M16
	63	165	125			77	18	3	20	41	4	M16
*	75	185		140	144	91	19	3	21	47	4	M16
*	90	200		153	159	108	19	5	22	56	8	M16
*	110	220		181	191	131	24	5	24	66	8	M20
*	140	250	215			165	23	5	28	91	8	M20
*	160	285	240			188	23	5	30	91	8	M20



Blanking flange PVC-U
Jointing face serrated metric

Model:

- Connecting dimension: ISO 7005 PN10, EN 1092 PN10, DIN 2501 PN10
- **d63 to d160: combined jointing face (serrated and flat)**
- d250: connecting dimension: ISO 2536
- **Bolt circle PN 10**

* Combined Flange, connecting dimensions EN1092 PN 10 and ANSI B 16.5 Class 150
 d20 - d110: bolt hole as long hole version

AL: number of holes

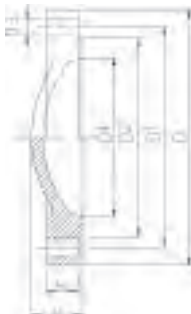

	Inch (inch)	DN (mm)	PN (bar)	d (mm)	Code	Weight (kg)
*	1/2	15	10	20	721 700 506	0.075
*	3/4	20	10	25	721 700 507	0.097
*	1	25	10	32	721 700 508	0.145
*	1 1/4	32	10	40	721 700 509	0.214
*	1 1/2	40	10	50	721 700 510	0.298
*	2	50	10	63	721 700 511	0.352
*	2 1/2	65	10	75	721 700 512	0.538
*	3	80	10	90	721 700 513	0.679
*	4	100	10	110	721 700 514	0.870
*	5	125	10	140	721 700 516	1.286
*	6	150	10	160	721 700 517	1.761
	8	200	10	225	721 700 520	2.731
	10	250	10	250	721 700 521	3.329
	10	250	10	280	721 700 522	3.769
	12	300	6	315	721 700 523	4.856
	14	350	6	355	721 700 524	6.972
	16	400	6	400	721 700 525	9.125

	D (mm)	D1 (mm)	D1 min. (mm)	D1 max. (mm)	D2 (mm)	D3 (mm)	D4 (mm)	H (mm)	H1 (mm)	AL
*	95		61	63	34	16	15	15	12	4
*	105		70	73	41	16	20	16	13	4
*	115		79	83	50	16	25	19	15	4
*	140		91	100	61	18	34	20	16	4
*	150		101	110	74	18	44	22	17	4
*	165		121	124	91	19	57	25	20	4
*	185		140	145	106	22	69	29	21	4
*	200		152	160	125	22	82	32	22	8
*	220		180	191	150	24	102	36	24	8
*	250	215			184	23	120	41	28	8
*	285	240			212	23	152	45	30	8
	340	295			261	22	213	63	36	8
	370	325			292	22	238	63	36	8
	395	350			320	22	266	65	36	12
	445	400			371	22	299	65	36	12
	505	460			430	22	341	67	38	16
	565	515			482	26	384	71	42	16

Branch and tapping saddles



Branch saddle

- Outlet with solvent cement socket metric
- Top saddle with rubber seal
- For operating pressure up to 10 bar water
- Seal: NBR (Nitrile-Rubber) shore hardness: 60 ±5 Shore A

d (mm)	Code	Weight (kg)	d1 (mm)	d2 (mm)	L (mm)
63	161 111 035	0.697	40	22	105
63	161 111 036	0.733	50	22	105
75	161 111 046	0.778	50	31	105
90	161 111 055	0.829	40	31	105
90	161 111 056	0.867	50	31	105
110	161 111 065	0.935	40	31	105
110	161 111 066	0.970	50	40	105
110	161 111 067	1.003	63	40	105
160	161 111 095	1.252	40	31	120
160	161 111 096	1.281	50	40	120
160	161 111 097	1.488	63	40	120
225	161 111 116	1.587	50	40	120
225	161 111 117	1.756	63	40	120



Repair saddle

- For repair of damaged pipes
- Saddle halves can be solvent cemented
- Cementing only possible on dry mains without pressure
- For operating pressure up to 10 bar water

d (mm)	Code	Weight (kg)	Max. pipe aperture (mm)	L (mm)
63	161 110 230	0.663	39	105
90	161 110 250	0.761	48	105
110	161 110 260	0.900	48	105
160	161 110 290	1.369	60	120
225	161 110 310	1.490	60	120



Tapping saddle with integral cutter

- For PVC pipes to tapping under operating pressure
- For operating pressure up to 10 bar water
- Top saddle with rubber seal
- Seal: NBR (Nitrile-Rubber) shore hardness: 60 ±5 Shore A
- Threaded outlet for PVP connections, 21.50.69
- Outlet 90° to main pipe
- Hexagon KEY for tapping: 799 150 007 (16 - 25 mm) 799 150 008 (32 - 40 mm) 799 150 009 (50 - 63 mm)

d (mm)	Code	Weight (kg)	d1 (mm)	Connection	Tapping-Ø (mm)	L (mm)
63	161 114 409	1.228	32	1	21	105
63	161 114 410	1.090	40	1 1/4	21	105
75	161 114 415	1.150	32	1	30	105
75	161 114 416	1.180	40	1 1/4	30	105
90	161 114 422	1.198	32	1	30	105
90	161 114 423	1.220	40	1 1/4	30	105
110	161 114 430	1.486	32	1	30	105
110	161 114 431	1.494	40	1 1/4	30	105
110	161 114 432	1.427	50	1 1/2	39	105
110	161 114 433	1.473	63	2	39	105
160	161 114 454	1.398	32	1	30	120
160	161 114 455	1.427	40	1 1/4	30	120
160	161 114 456	1.998	50	1 1/2	39	120
160	161 114 457	2.351	63	2	39	120
225	161 114 470	2.023	32	1	30	120
225	161 114 471	2.024	40	1 1/4	30	120
225	161 114 472	1.963	50	1 1/2	39	120
225	161 114 473	2.503	63	2	39	120

Saddles



Saddle single branch (rubber gasket joint to main)

Model:

- Outlet with solvent cement socket, BS Inch
- Top saddle with NBR rubber gasket

d1-d (mm)	PN (bar)	Code	Weight (kg)	L (mm)
1 1/4 - 3"	10	161 117 055	0.343	106
1 1/2 - 3"	10	161 117 056	0.363	106
2 - 3"	10	161 117 057	0.767	106
1 1/4 - 4"	10	161 117 065		106
1 1/2 - 4"	10	161 117 066	0.405	106
2 - 4"	10	161 117 067	0.930	106
1 1/4 - 6"	10	161 117 095	0.550	120
1 1/2 - 6"	10	161 117 096		120
2 - 6"	10	161 117 097	1.364	120



Saddle double branch (rubber gasket joint to main)

Model:

- Top saddle with NBR rubber gasket
- Outlet with solvent cement socket, BS Inch
- Allowance should be made for a possible weakening effect on the main of the two diametrically opposed tapings. Particular attention should therefore be given to the class of pipe used in relation to the expected maximum working pressures.

d-d (inch)	PN (bar)	Code	Weight (kg)	L (mm)	L1 (mm)
1 1/4 - 3	10	161 137 055	0.800	106	88
1 1/2 - 3	10	161 137 056	0.840	106	88
2 - 3	10	161 137 057	0.851	106	88
1 1/4 - 4	10	161 137 065	0.910	106	101
1 1/2 - 4	10	161 137 066	0.930	106	101
2 - 4	10	161 137 067	0.954	106	101
1 1/4 - 6	10	161 137 095	1.250	120	121
1 1/2 - 6	10	161 137 096		120	121
2 - 6	10	161 137 097	1.332	120	121

Installation fittings

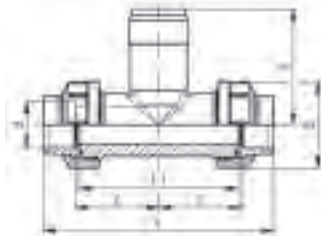

Installation fitting type 310 PVC-U For socket systems metric

Range of use:

- Compatible Signet flow sensors: type 2551, 2537, 515, 8510, 2536, 8512
- Compatible Signet pH/ORP sensors: type 2724, 2725, 2726, 2734, 2736, 2735

Attention:

- sensor length depends on installation fitting

Model:

- Threaded outlet 1 ¼" NPSM
- Union end with solvent cement socket PVC-U

d (mm)	DN (mm)	PN (bar)	EPDM Code	Weight (kg)	FPM Code	Weight (kg)
20	15	16	721 310 006	0.181	721 310 036	0.181
25	20	16	721 310 007	0.226	721 310 037	0.226
32	25	16	721 310 008	0.303	721 310 038	0.304
40	32	16	721 310 009	0.419	721 310 039	0.479
50	40	16	721 310 010	0.568	721 310 040	0.571
63	50	16	721 310 011	0.879	721 310 041	0.881

d (mm)	DN (mm)	L1 (mm)	D (mm)	H (mm)	L (mm)	Sensor Type	z (mm)
20	15	90	43	76	128	flow X0, pH XX	48
25	20	100	51	78	144	flow X0, pH XX	53
32	25	110	58	81	160	flow X0, pH XX	58
40	32	110	72	85	168	flow X0, pH XX	58
50	40	120	83	89	188	flow X0, pH XX	63
63	50	130	100	95	212	flow X0, pH XX	68

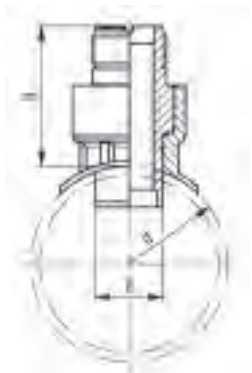

Installation fitting type 312 PVC-U metric glue on saddle

Model:

- Top saddle for solvent cement bonding
- Saddle with threaded outlet 1 ¼" NPSM

Range of use:

- Compatible Signet flow sensors: type 2551, 2537, 515, 8510, 2536, 8512

Attention:

- sensor length depends on installation fitting

PN (bar)	DN (mm)	d (mm)	Code	Weight (kg)	D (mm)	Sensor Type	H (mm)
10	65	75	721 312 012	0.220	38	flow X1	89
10	80	90	721 312 013	0.228	38	flow X1	89
10	100	110	721 312 014	0.225	38	flow X1	89
10	100	125	721 312 015	0.218	38	flow X1	81
10	125	140	721 312 016	0.213	38	flow X1	79
10	150	160	721 312 017	0.217	38	flow X1	76
10	200	200	721 312 019	0.192	38	flow X1	69
10	200	225	721 312 020	0.297	38	flow X2	141
10	250	250	721 312 021	0.295	38	flow X2	137
10	300	315	721 312 023	0.290	38	flow X2	127



Installation fitting type 312
PVC-U metric clamp on saddle

Model:

- Saddle with threaded outlet 1 ¼" NPSM
- Top saddle for solvent cement bonding
- Seal: Lip seal EPDM

Range of use:

- Compatible Signet flow sensors: type 2551, 2537, 515, 8510, 2536, 8512
- Compatible Signet pH/ORP sensors: type 2724, 2725, 2726, 2734, 2736, 2735

Attention:

- sensor length depends on installation fitting

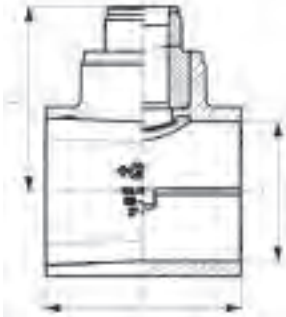

DN (mm)	PN	d (mm)	Code	Weight (kg)	Sensor Type	H (mm)	L (mm)
65	16	75	198 150 538	0.780	flow X0, pH XX	99	105
80	16	90	198 150 539	0.835	flow X0, pH XX	105	105
100	16	110	198 150 540	0.885	flow X0, pH XX	114	105
150	16	160	198 150 543	1.375	flow X1	157	120
200	16	225	198 150 545	1.700	flow X1	184	120



Installation fitting type 314
PVC-U metric

Model:

- Threaded outlet 1 ¼" NPSM
- For conventional hot gas back welding according to DVS 2207 part 3

Attention:

- only for pressureless or low pressure application
- pressure rate depends on quality of hot gas back welding
- please consult the instruction manual
- Installation by trained and certified welders only
- sensor length depends on installation fitting

Range of use:

- Compatible Signet flow sensors: type 2551, 2537, 515, 8510, 2536, 8512
- Compatible Signet pH/ORP sensors: type 2724, 2725, 2726, 2734, 2736, 2735



DN	d (mm)	PN* (bar)	Code	Weight (kg)	Sensor Type	D (mm)	L (mm)
65 - 150	75 - 180	-	721 314 000	0.053	flow X0, pH XX	38	68
200 - 350	200 - 355	-	721 314 001	0.078	flow X1	38	102
350 - 600	400 - 630	-	721 314 002	0.153	flow X2	38	178